

Fixing the plates to the cabinet sides.

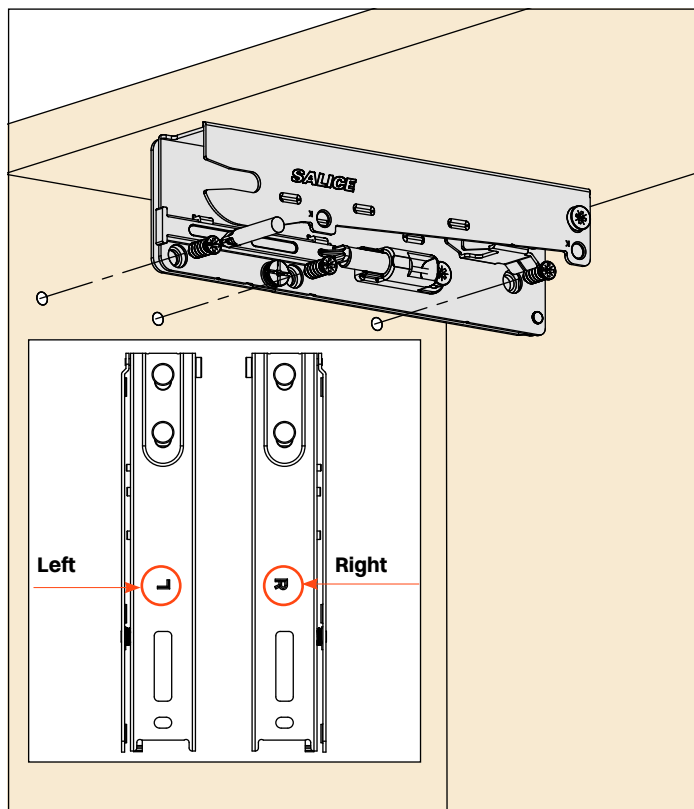

Screw the hinge to the door.

Insert the hinge into the appropriate coupling seats with slight pressure.

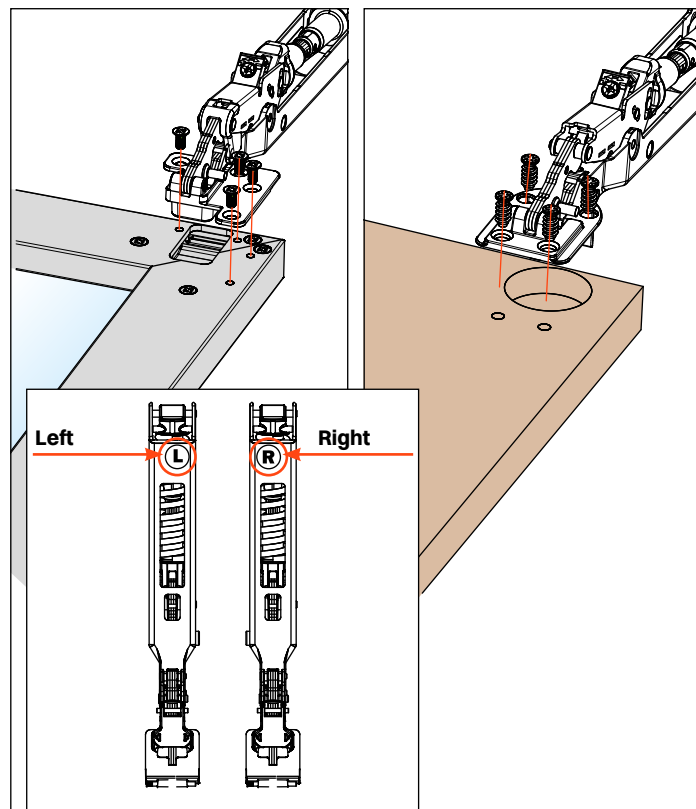

Inserting the hinge into the plates.

Insert the hinge into the plate until the back fixing is engaged.
This operation is tool free.

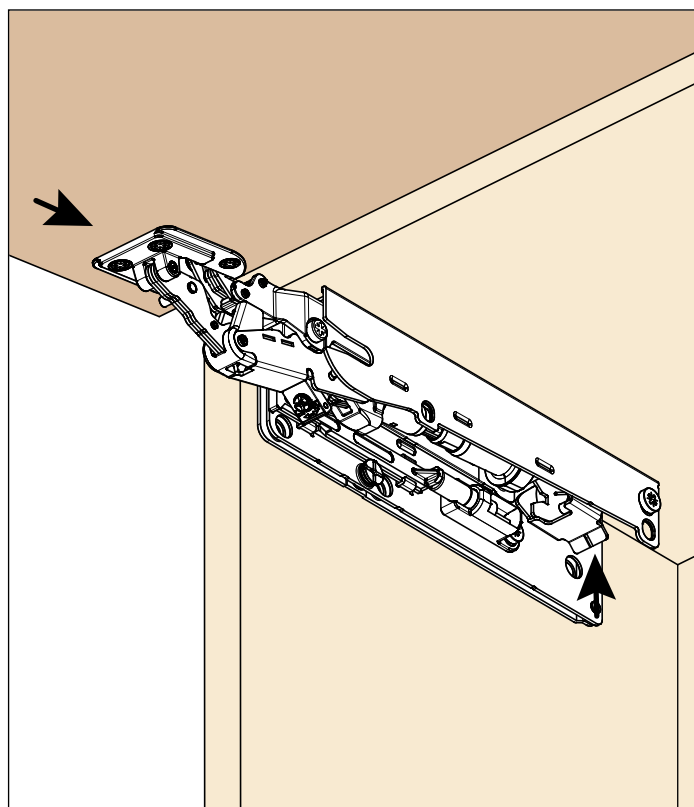



WARNING ! Security cable ties.

Remove the cable ties only at the end of the assembly.
Use the instructions and the QR Code attached to the hinges.

Installing the covers.

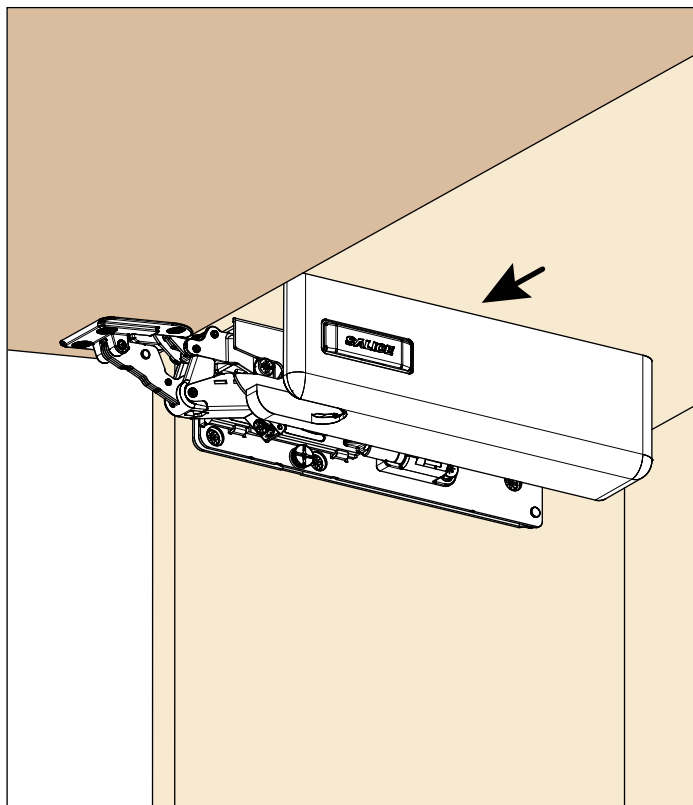

Adjustments.

- 1 - adjustment of the spring strength.
- 2 - adjustment of the decelerating effect.
- 3 - extension/adjustment of the opening angle of the door.

- 4 - height adjustment of the door from - 2 to +2.
- 5 - sideways adjustment of the door from - 2 to +2.
- 6 - depth adjustment of the door from -1.5 to +2.5.

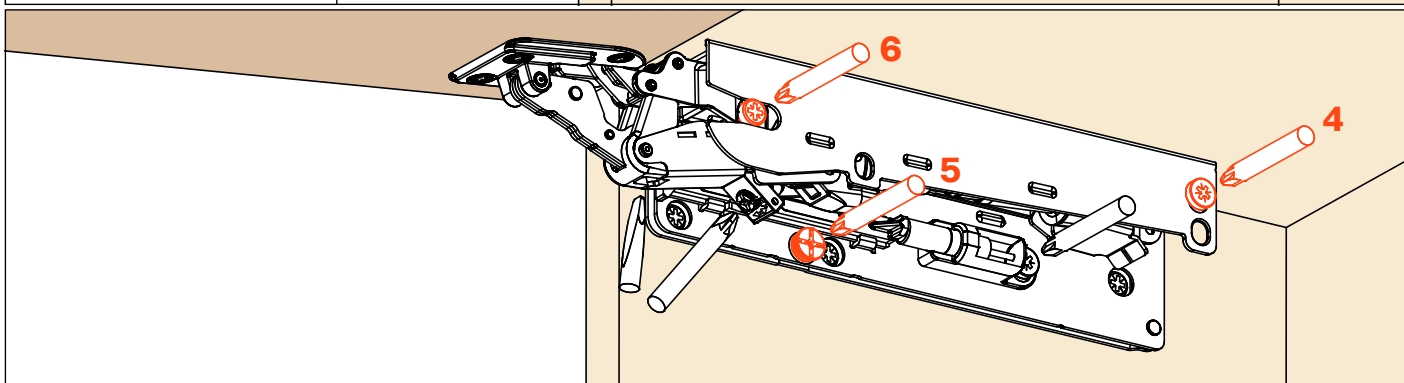
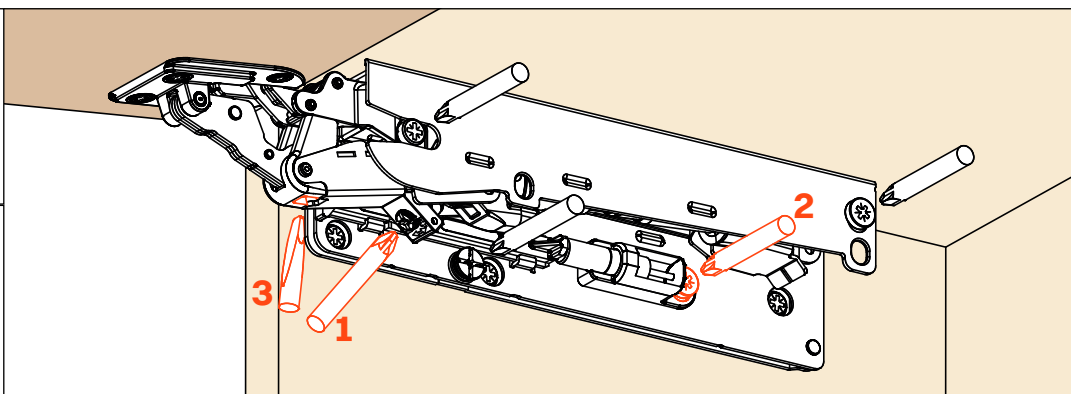
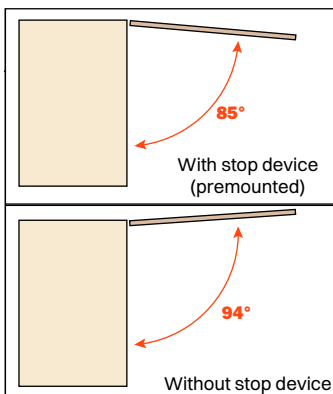

Wind

Disassembly instructions

Removal of the covers.

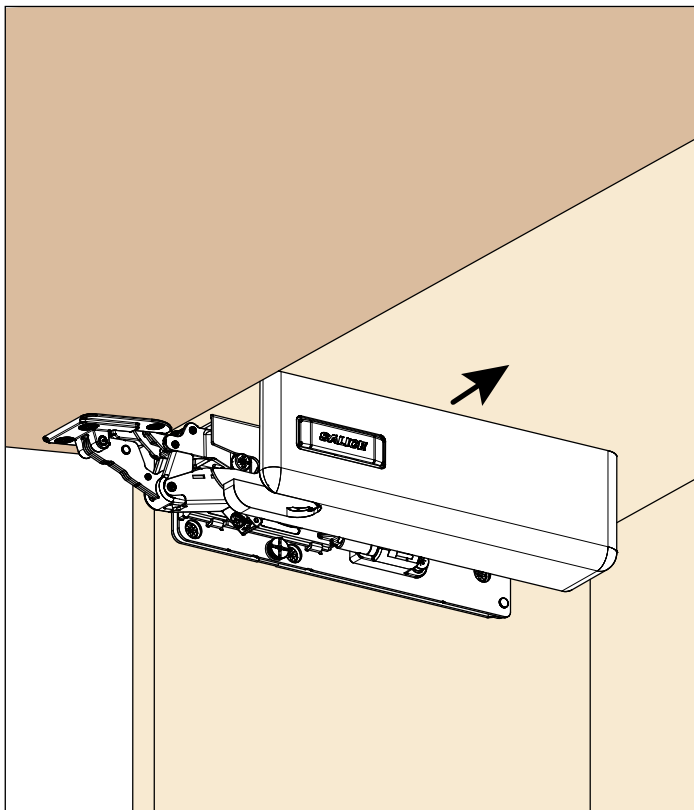

Disassembly of the hinge.

Press the back lever and pull out the hinge.
This operation is tool free.

