

## Modular shelf

### Aluminium frame H 36

**VE80DAHA0133B** = Hanger rail for clothes, 1000 mm length

**VE80DAHA0233B** = Hanger rail for clothes, 1500 mm length

**VE80GMRA00533B** = Side rail-holder supports

#### Hanger rail for clothes and rail-holder supports for shelf with aluminium frame H 36

- Hanger rail material: epoxy-coated aluminium, section 15 x 30 mm
- Supports material: epoxy-coated die-cast
- Finish: metal grey brown
- Max. recommended load capacity:
  - up to 1200 mm width: 30 Kg
- Packing: 20 pieces per box.

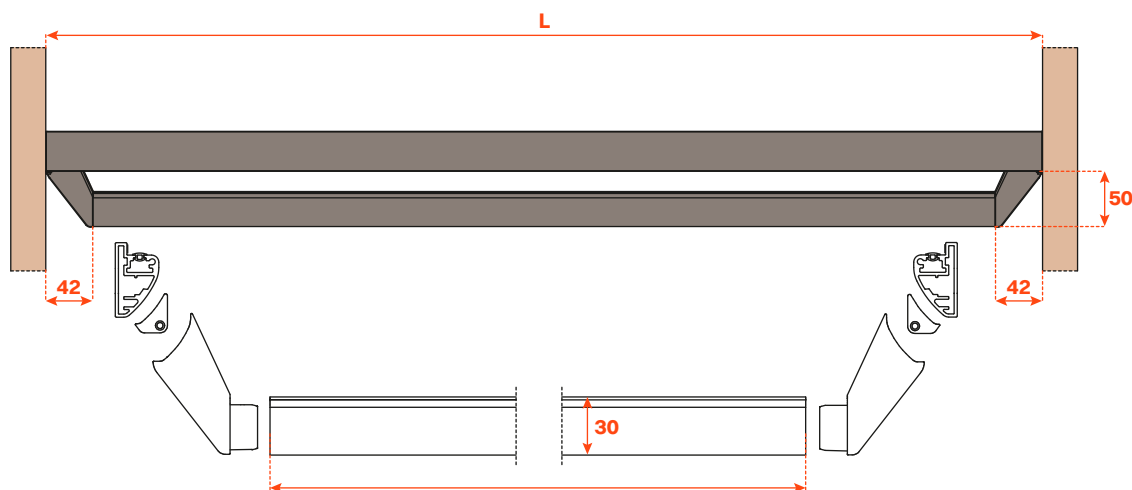

Hanger rail length = Shelf width - 84 mm

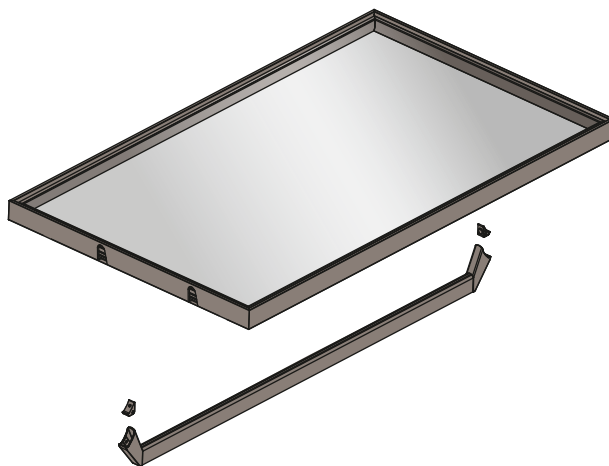

Grub screw to remove before starting the operation

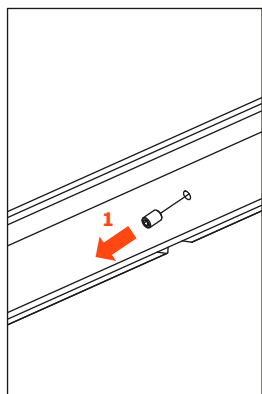

Screw-fix the adapters to the shelf

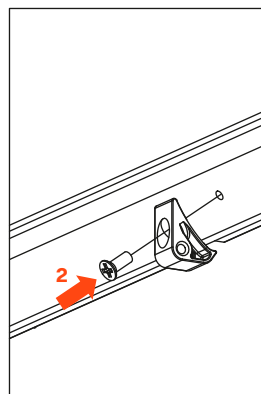

Insert the hanger rail into the rail-holders and insert them into the adapters

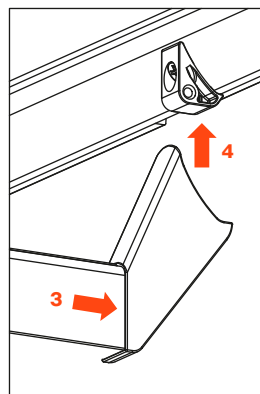

Screw-fix the rail-holders to the adapters

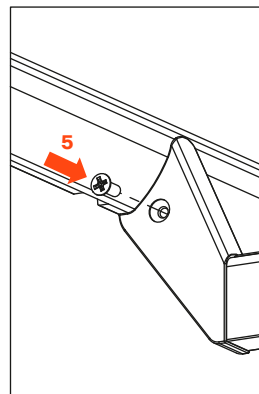

Front view

