



## **Lineabox<sup>Easy</sup>**

### **Front panel for internal drawer**

## Lineabox Easy - Front panel for internal drawer - H 101 mm



**Height of Lineabox Easy side 101 mm.**

**Max. height of front panel 126 mm.**

**For use with Progressa and Futura full-extension runners.**

- Included material:
  - aluminium for front panel
  - plastic for front panel adapters
  - metal for covers
- Complementary material:
  - Lineabox Easy: to choose between 2-Sided, 2-Sided - Inset Back and 3-Sided
  - Rapid assembly system, with no machinery needed
  - Frontal fixings are already premounted
  - Rapid mounting and removal of front panel
  - Finishes: White - Slate grey - Champagne - Stainless steel

### Assembly details (The example shows the frontal assembled with Lineabox Easy 2-Sided)

Cut the front panel to length

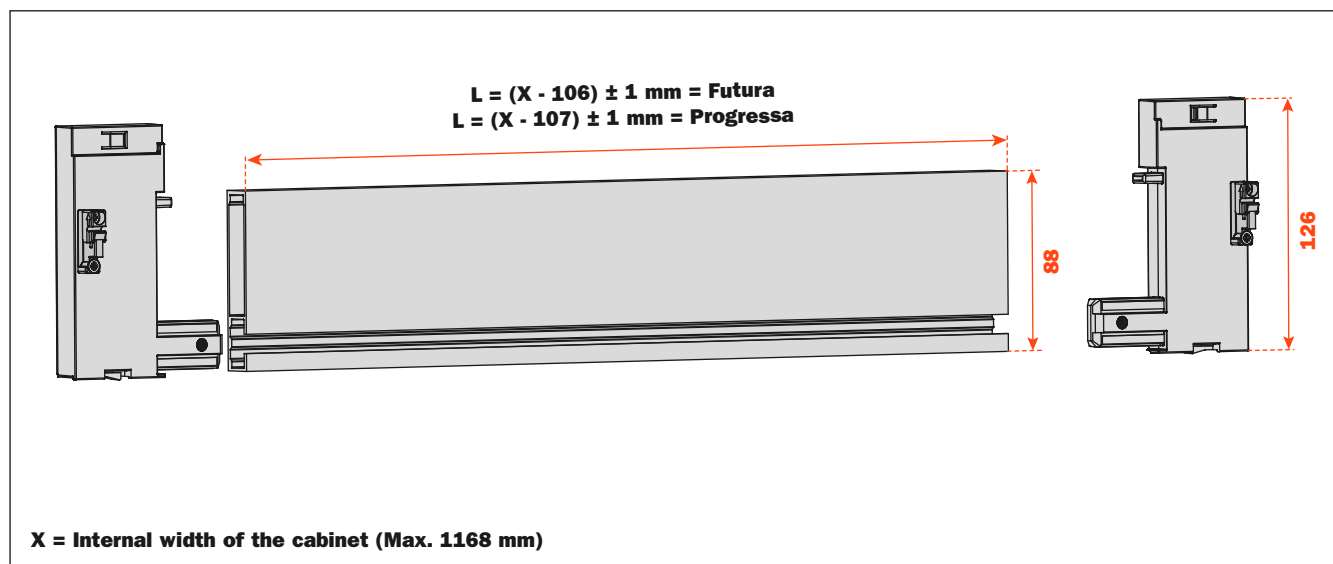

Insert the front panel adapters into the front panel and tighten the locking screws.  
Frontal fixings are already premounted.

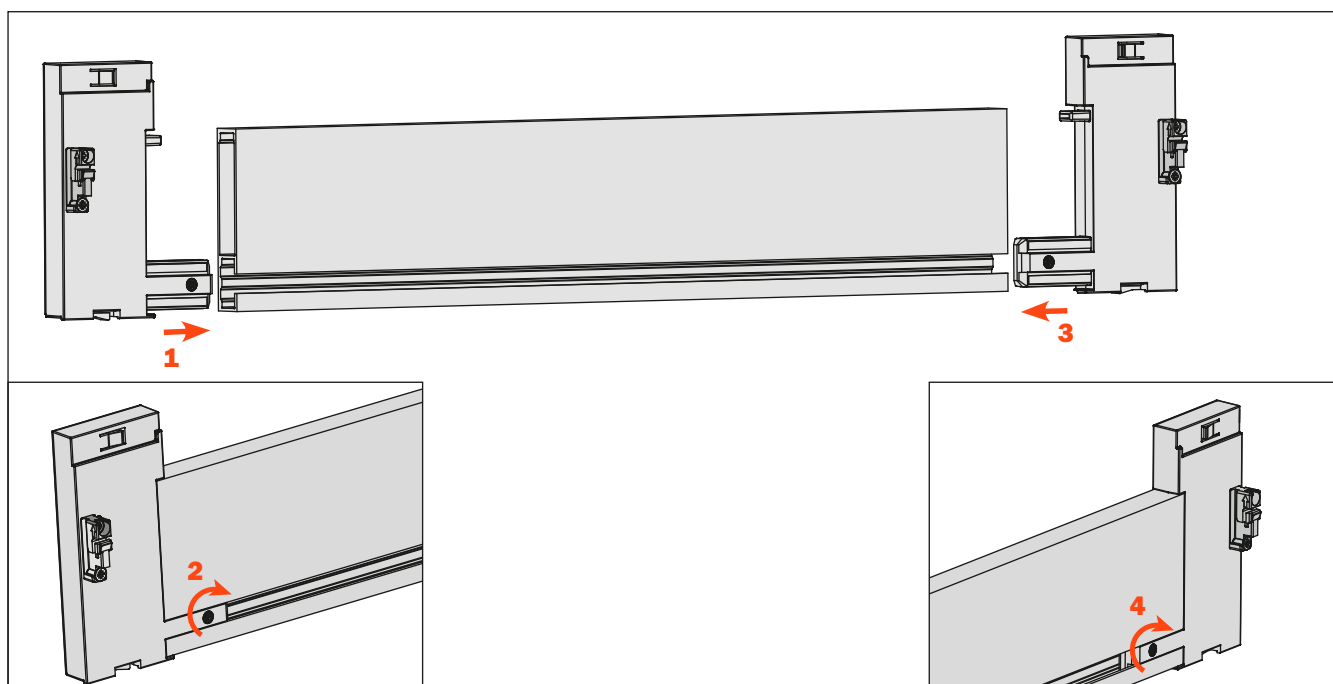

Fix the front panel to the drawer

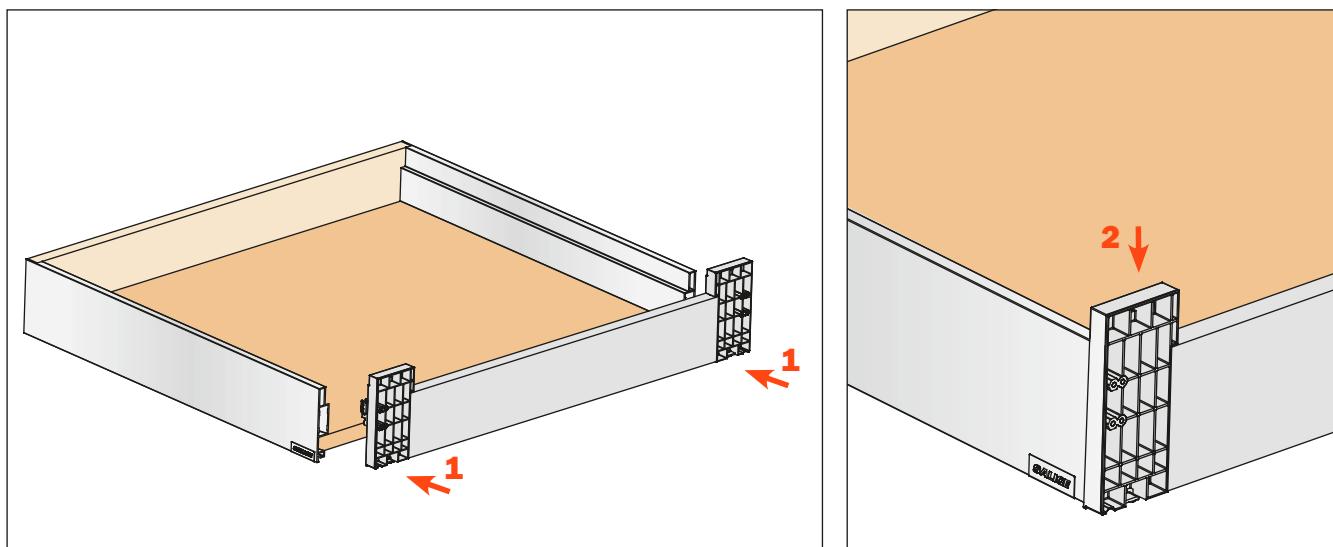

Fix the covers

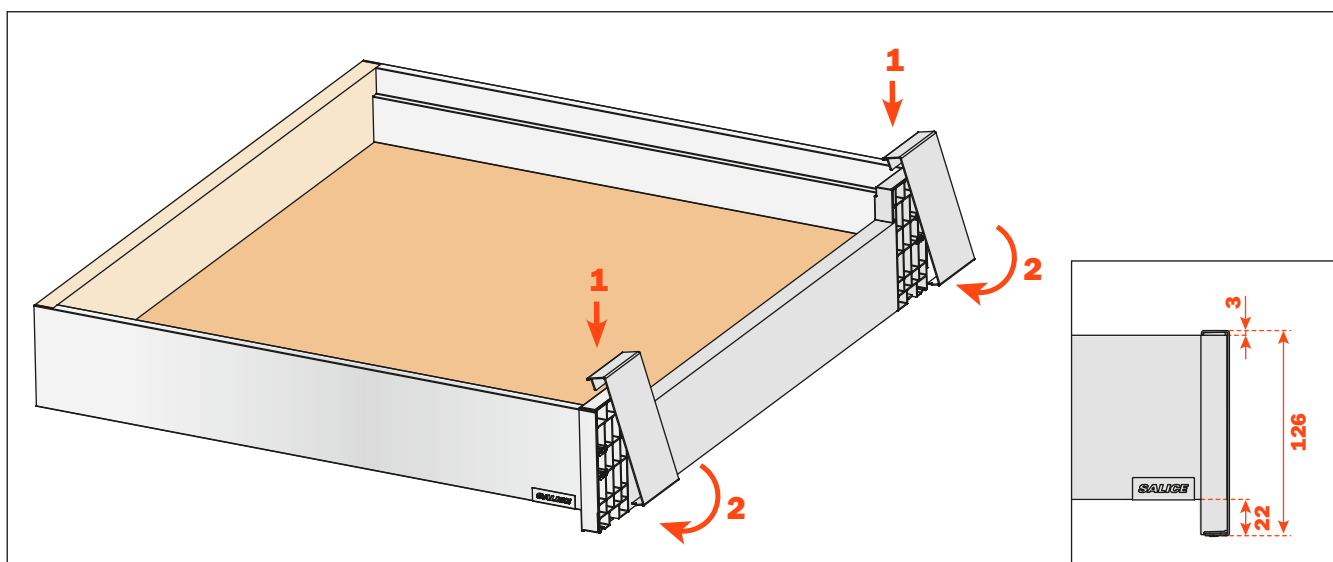

To correct any possible cutting errors of the panel, loosen and retighten the indicated screws

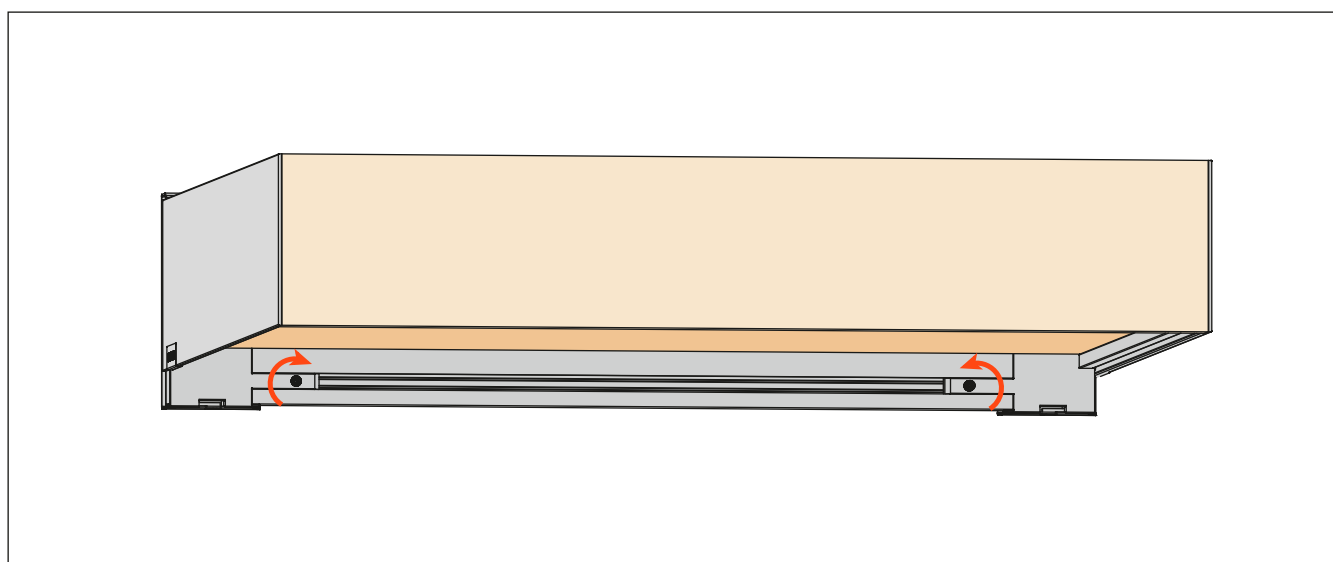

## Lineabox Easy - Front panel for internal drawer - H 178 mm

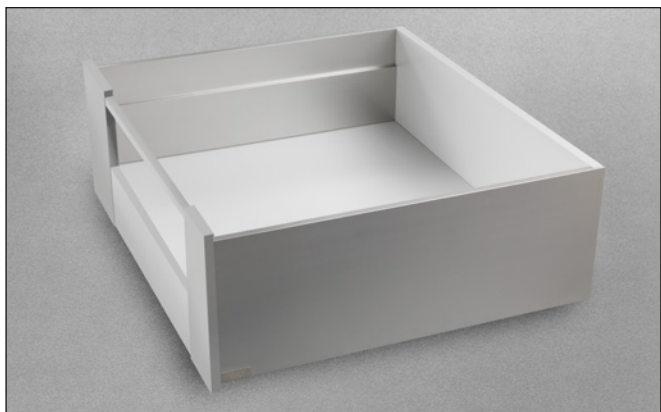

**Height of Lineabox Easy side 178 mm.**  
**Max. height of front panel 203 mm.**  
**For use with Progressa and Futura full-extension runners.**

- Included material:
  - aluminium for front panel and railing
  - plastic for front panel adapters
  - metal for covers
- Complementary material:
  - Lineabox Easy: to choose between 2-Sided, 2-Sided - Inset Back and 3-Sided
  - Rapid assembly system, with no machinery needed
  - Frontal fixings are already premounted
  - Rapid mounting and removal of front panel
  - Finishes: White - Slate grey - Champagne - Stainless steel

### Assembly details (The example shows the frontal assembled with Lineabox Easy 2-Sided)

Cut the front panel and the railing to length

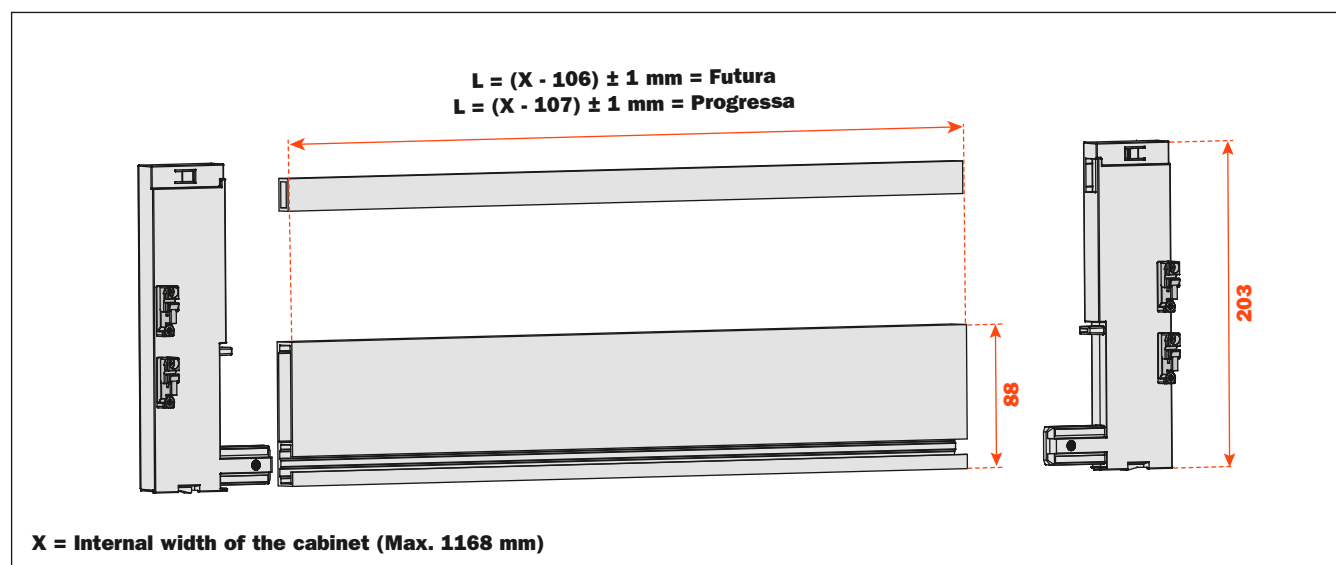

Insert the front panel adapters into the front panel and the railing and tighten the locking screws.  
 Frontal fixings are already premounted.

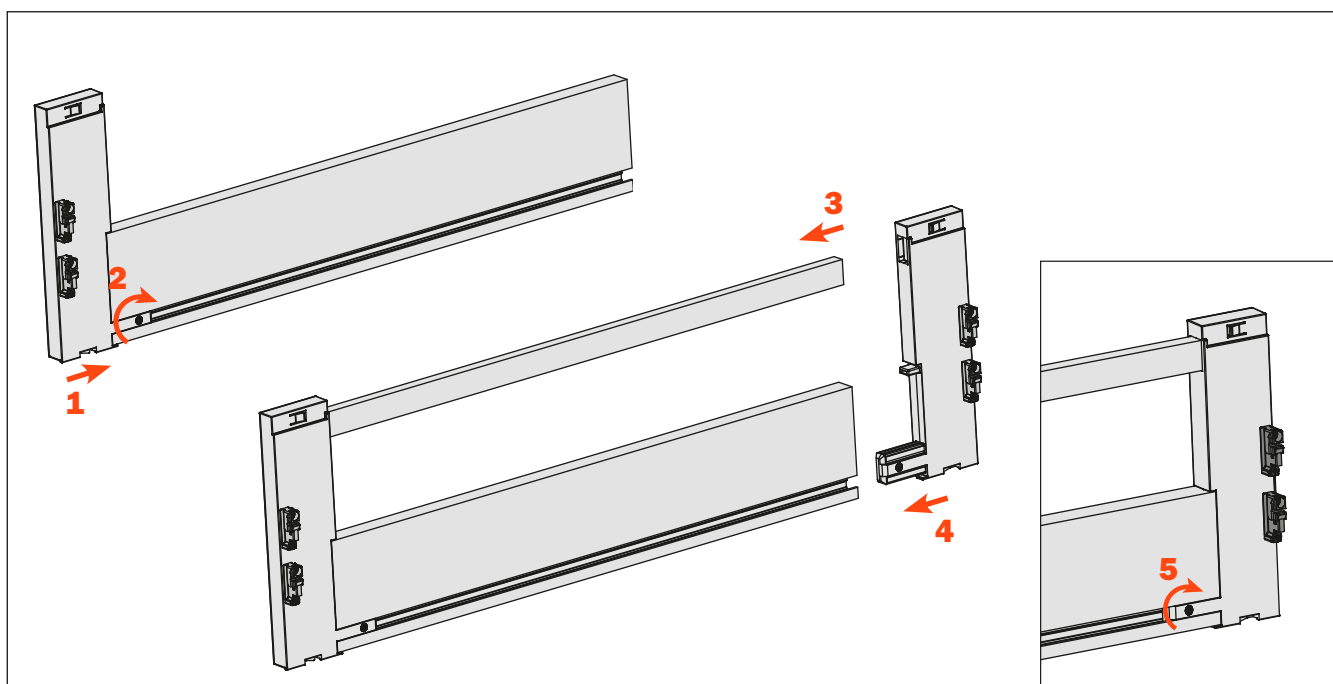

Fix the front panel to the drawer

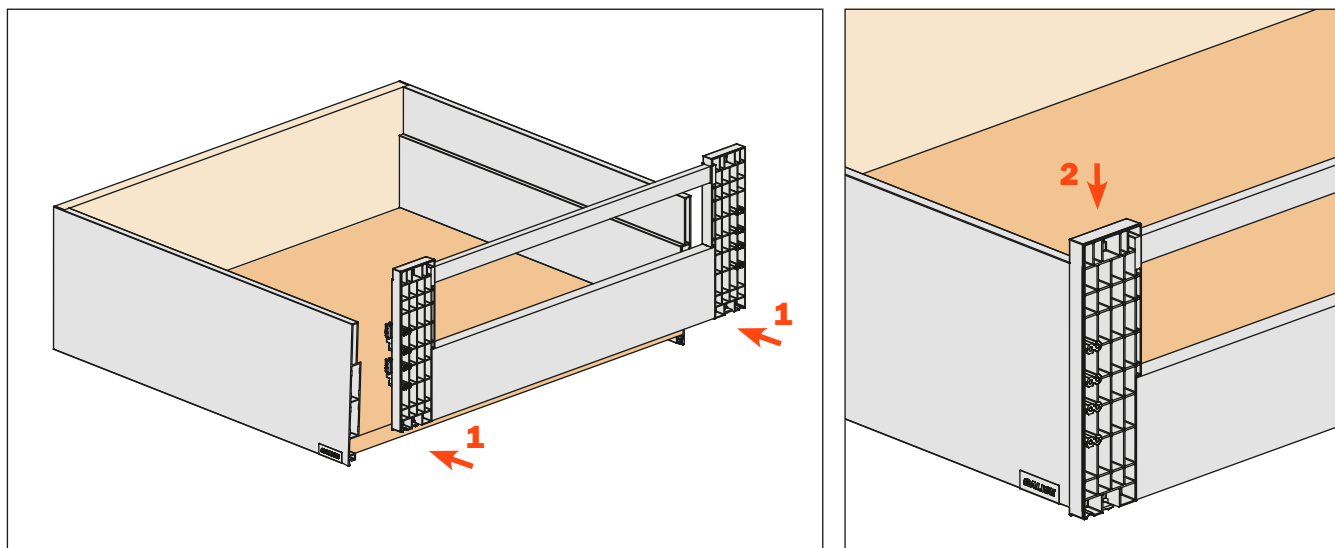

Fix the covers

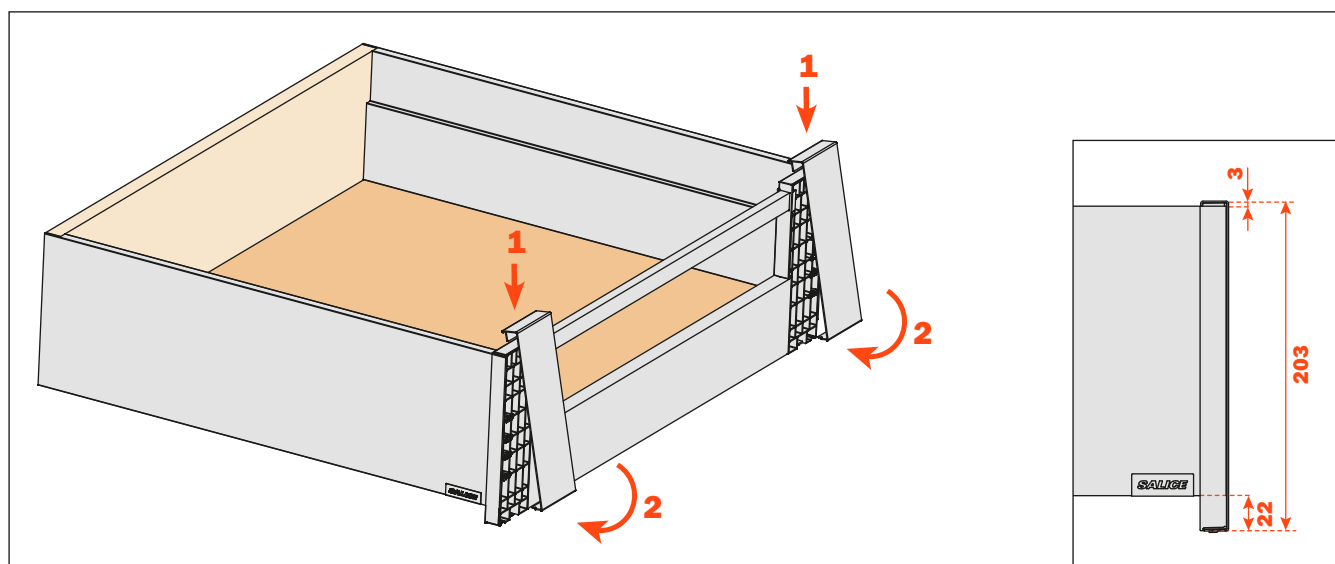

To correct any possible cutting errors of the panel, loosen and retighten the indicated screws

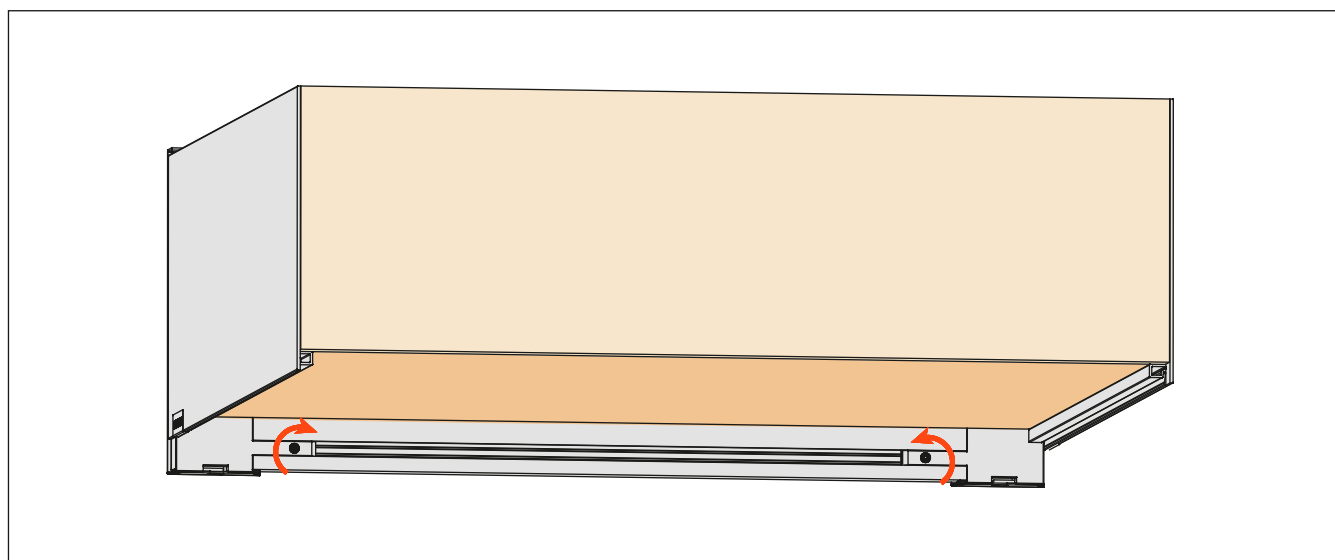

## Lineabox Easy - Front panel for internal drawer with insert - H 101 mm

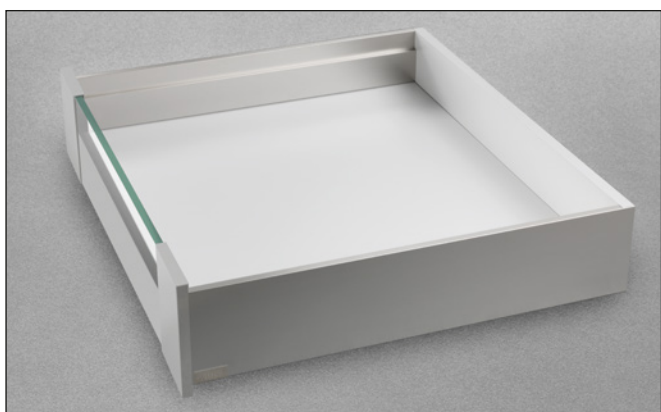

**Height of Lineabox Easy side 101 mm.**  
**Max. height of front panel 126 mm.**  
**For use with Progressa and Futura full-extension runners.**

- Included material:
  - aluminium for front panel
  - plastic for front panel adapters
  - metal for covers
- Complementary material:
  - Lineabox Easy: to choose between 2-Sided, 2-Sided - Inset Back and 3-Sided
  - decorative insert not included
  - Rapid assembly system, with no machinery needed
  - Frontal fixings are already premounted
  - Rapid mounting and removal of front panel
  - Finishes: White - Slate grey - Champagne - Stainless steel

### Assembly details (The example shows the frontal assembled with Lineabox Easy 2-Sided)

Cut the front panel and the insert to length

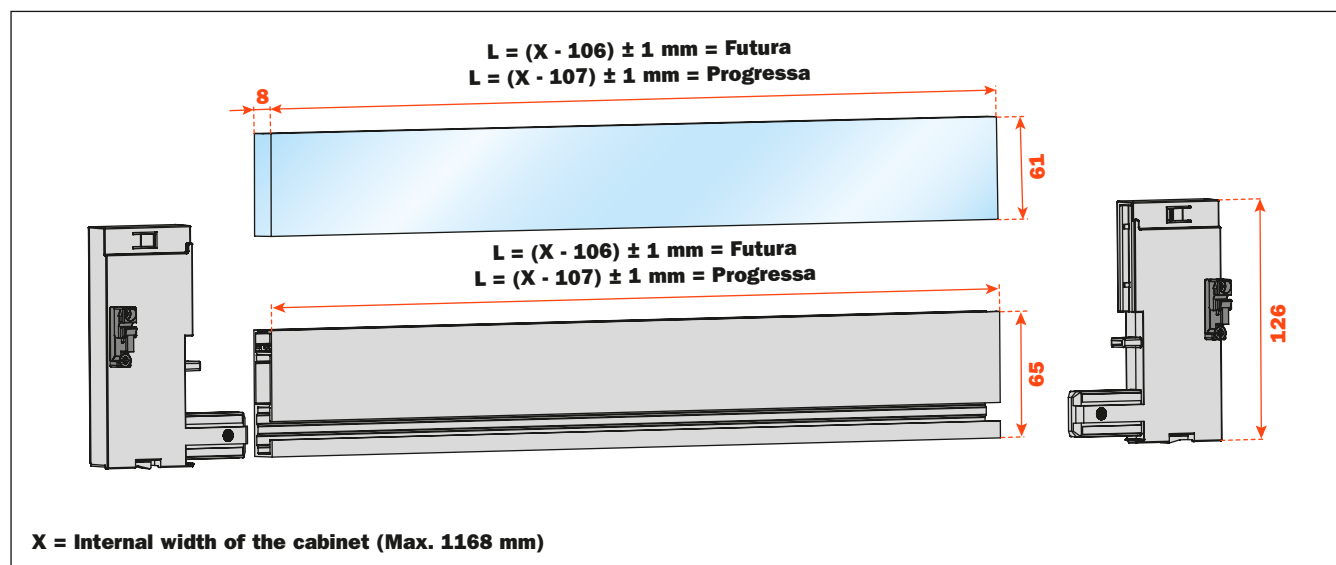

Insert the front panel adapters into the front panel and tighten the locking screws.  
 Frontal fixings are already premounted.

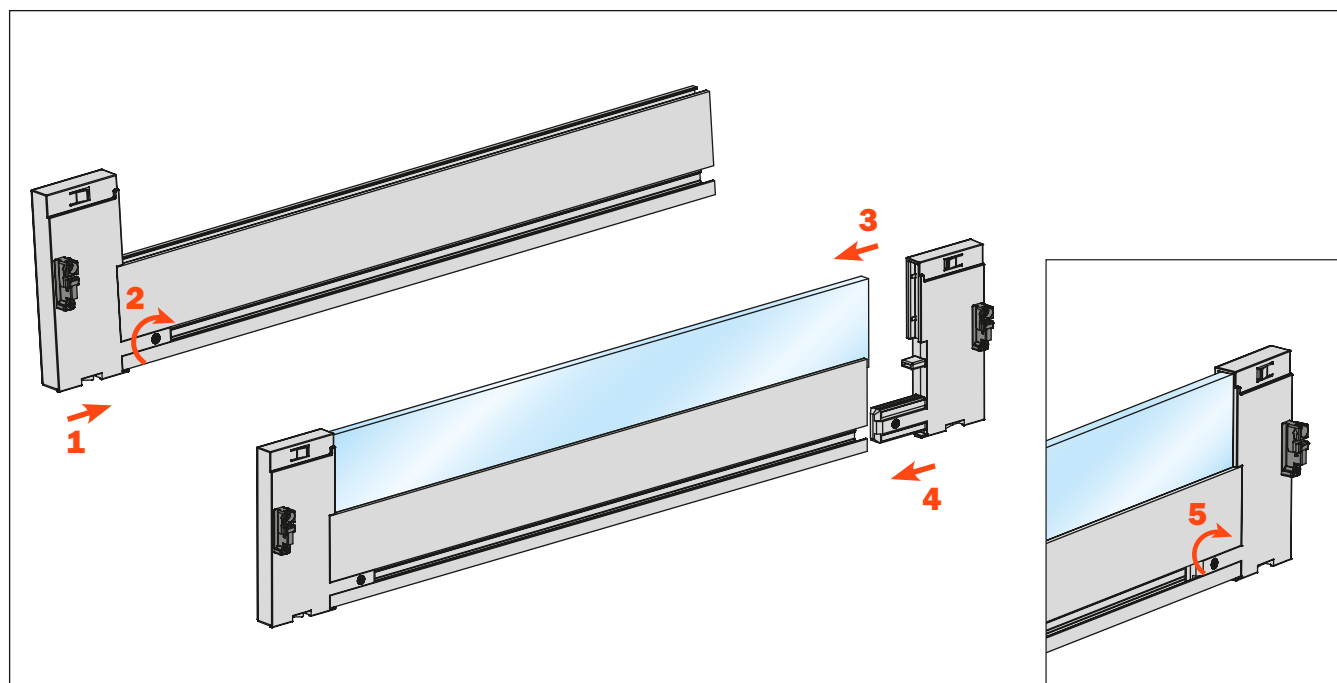

Fix the front panel to the drawer

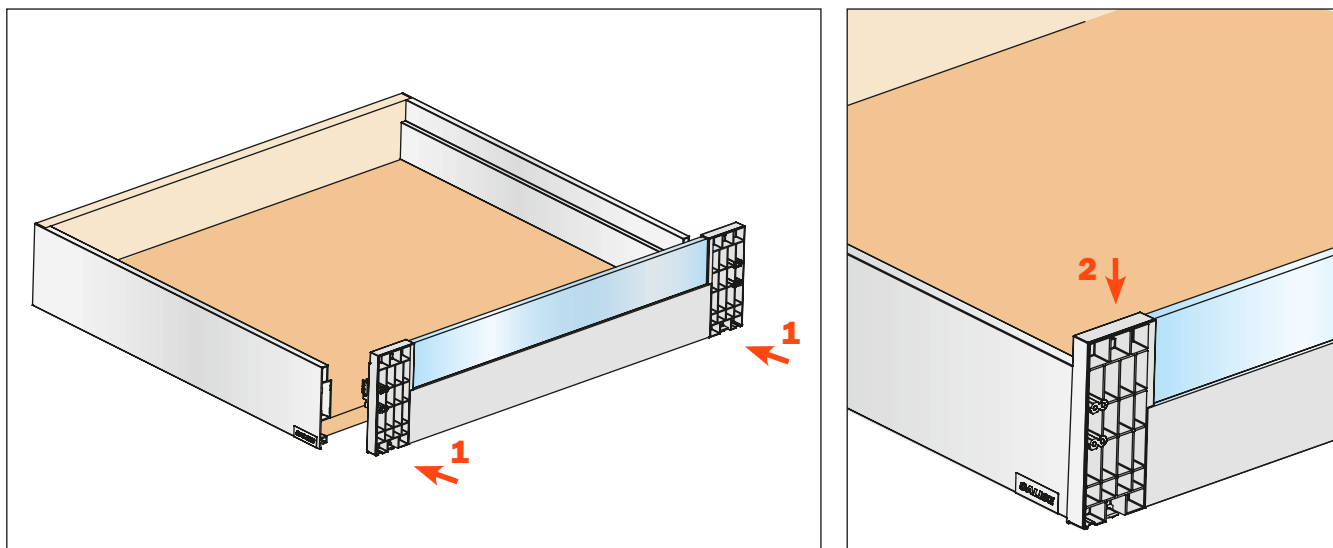

Fix the covers

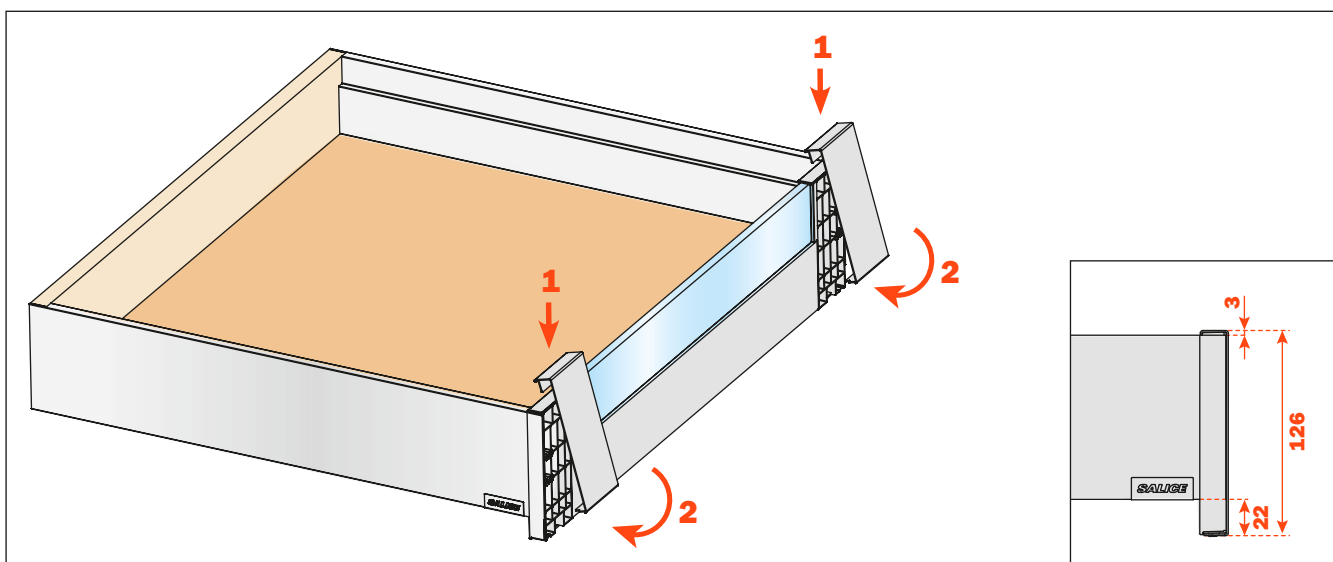

To correct possible cutting errors of the panel, loosen and retighten the indicated screws

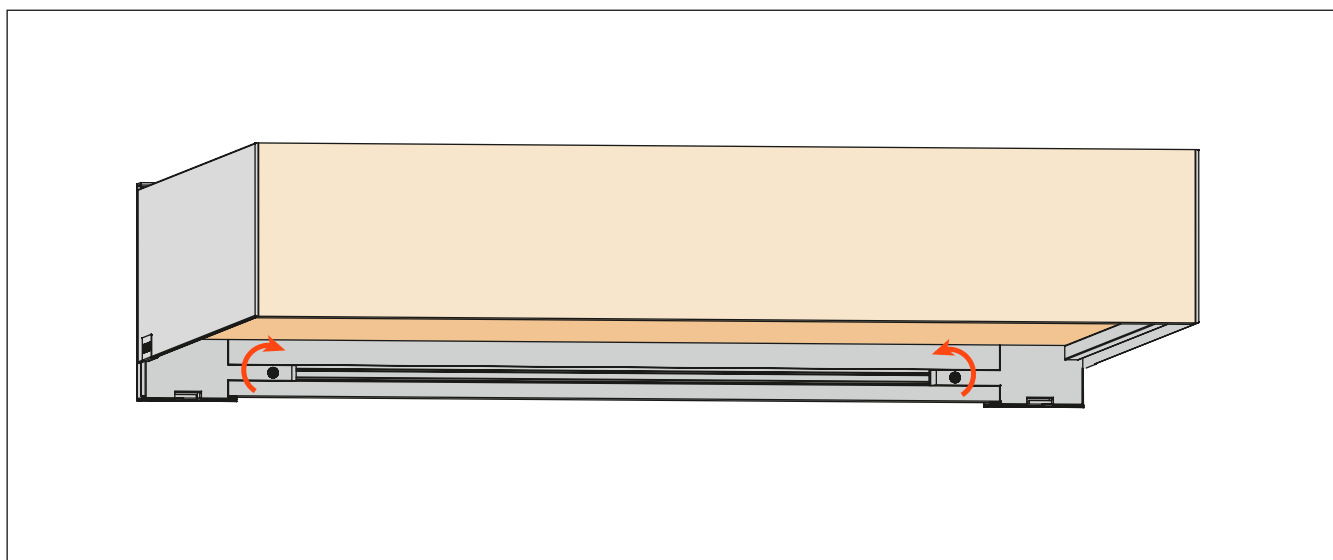

## Lineabox Easy - Front panel for internal drawer with insert - H 178 mm

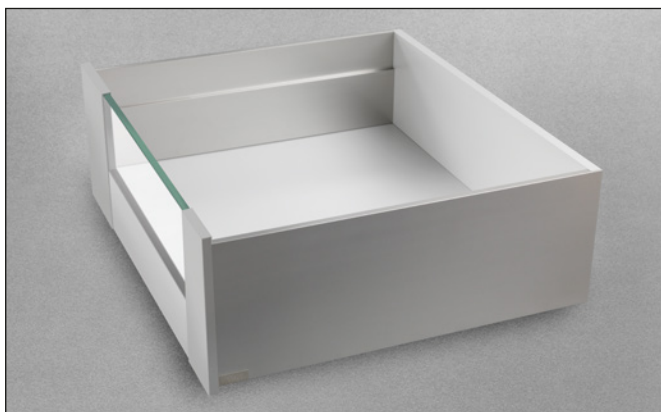

**Height of Lineabox Easy side 178 mm.**

**Max. height of front panel 203 mm.**

**For use with Progressa and Futura full-extension runners.**

- Included material:
  - aluminium for front panel
  - plastic for front panel adapters
  - metal for covers
- Complementary material:
  - Lineabox Easy: to choose between 2-Sided, 2-Sided - Inset Back and 3-Sided
  - decorative insert not included
  - Rapid assembly system, with no machinery needed
  - Frontal fixings are already premounted
  - Rapid mounting and removal of front panel
  - Finishes: White - Slate grey - Champagne - Stainless steel

### Assembly details (The example shows the frontal assembled with Lineabox Easy 2-Sided)

Cut the front panel and the insert to length

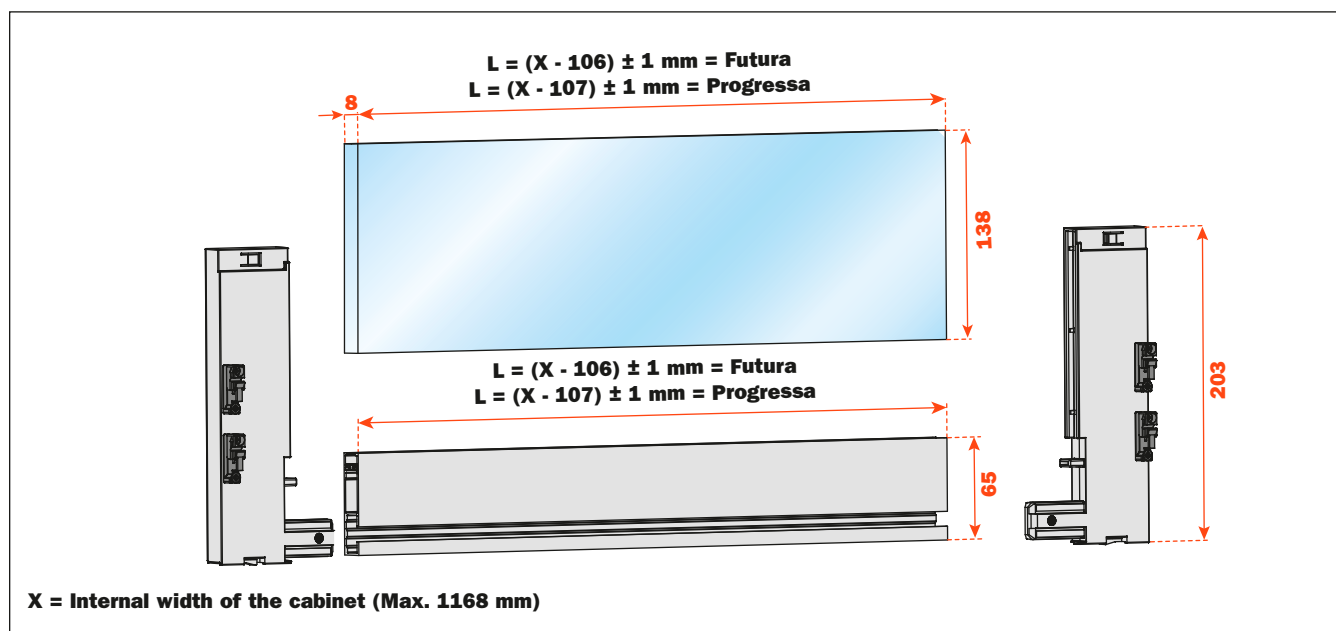

Insert the front panel adapters into the front panel and tighten the locking screws.  
 Frontal fixings are already premounted.

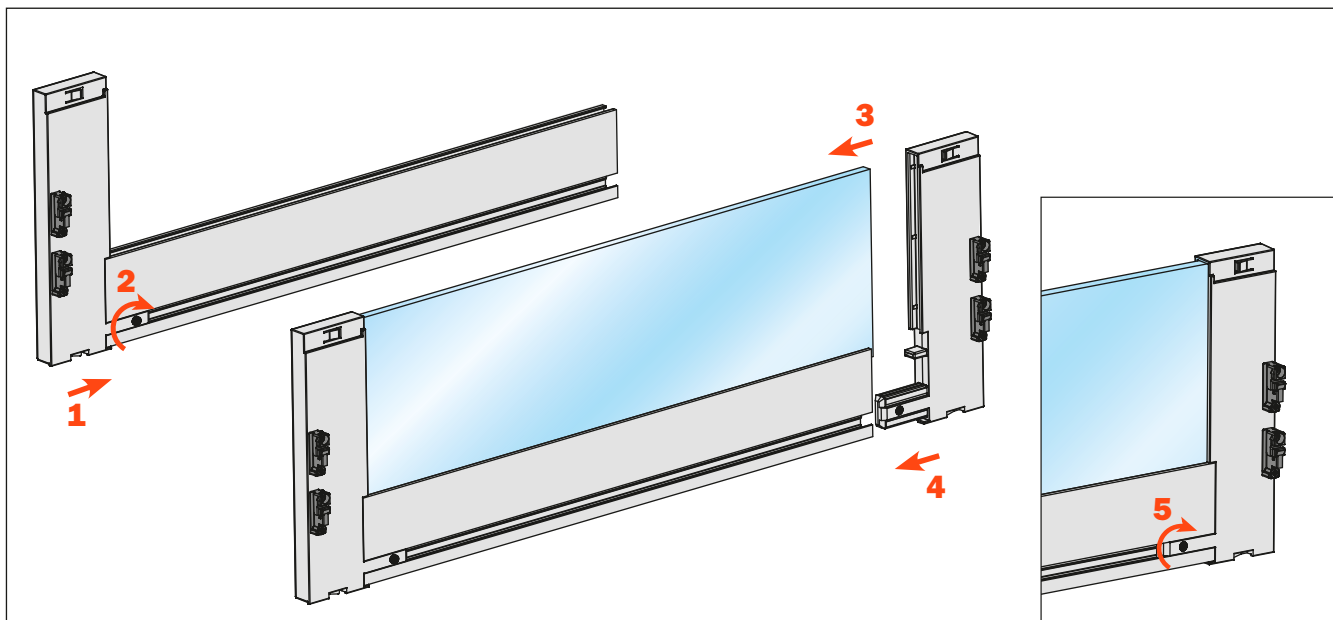

Fix the front panel to the drawer

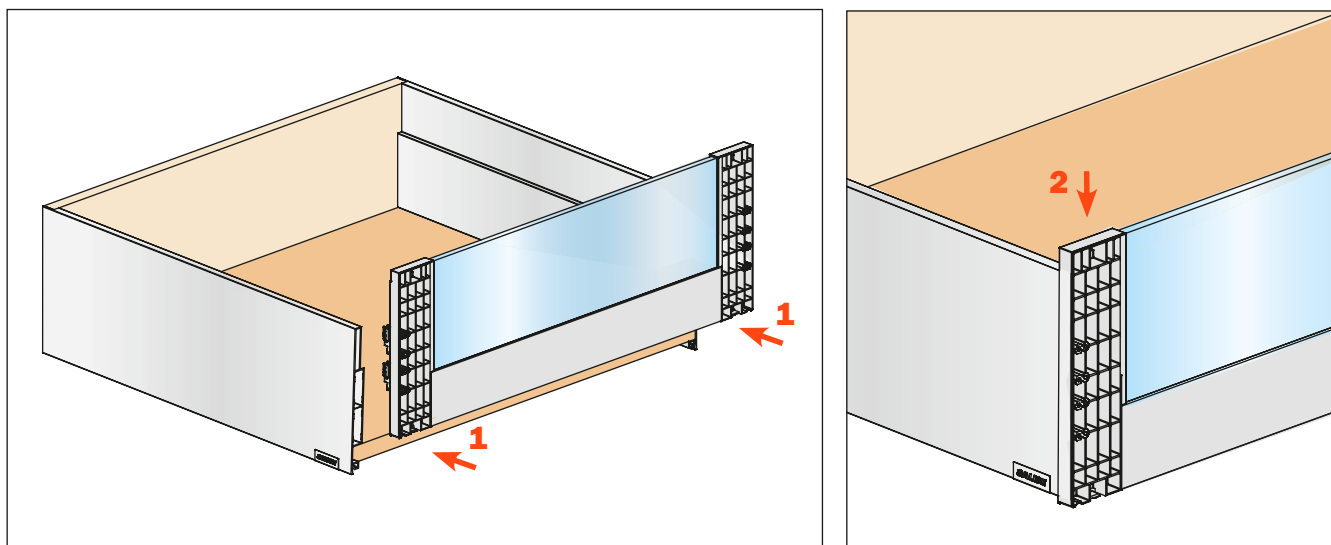

Fix the covers

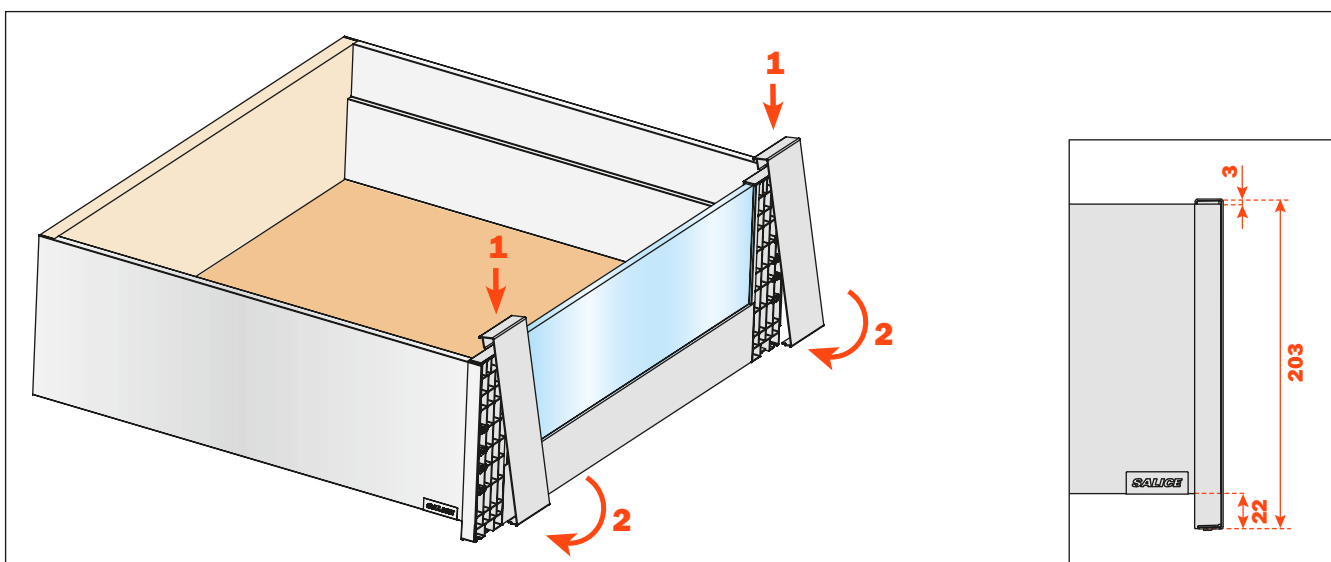

To correct any possible cutting errors of the panel, loosen and retighten the indicated screws

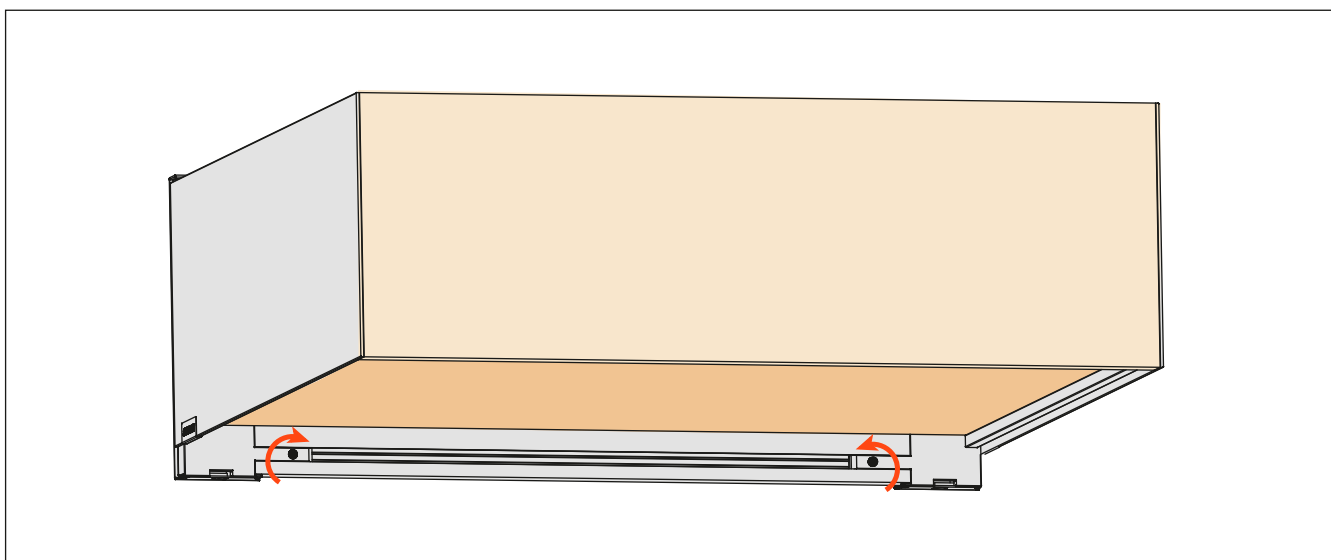

## Lineabox Easy - Front panel for internal drawer - H 75 mm

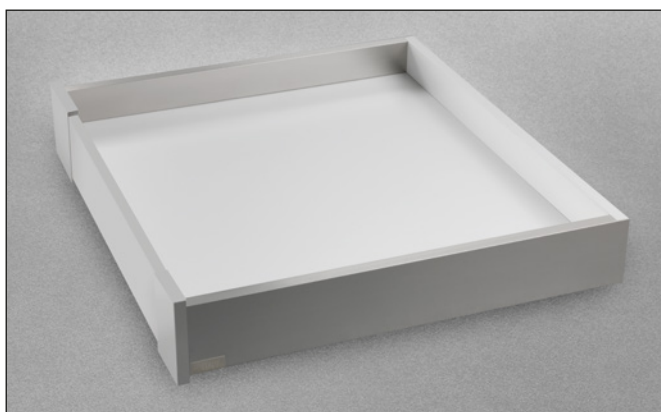

**Height of Lineabox Easy side 75 mm.**

**Max. height of front panel 100 mm.**

**For use with Progressa and Futura full-extension runners.**

- Included material:
  - aluminium for front panel
  - plastic for front panel adapters
  - metal for covers
- Complementary material:
  - Lineabox Easy: to choose between 2-Sided, 2-Sided - Inset Back and 3-Sided
  - Rapid assembly system, with no machinery needed
  - Frontal fixings are already premounted
  - Rapid mounting and removal of front panel
  - Finishes: White - Slate grey - Champagne - Stainless steel

### Assembly details (The example shows the frontal assembled with Lineabox Easy 2-Sided)

Cut the front panel to length

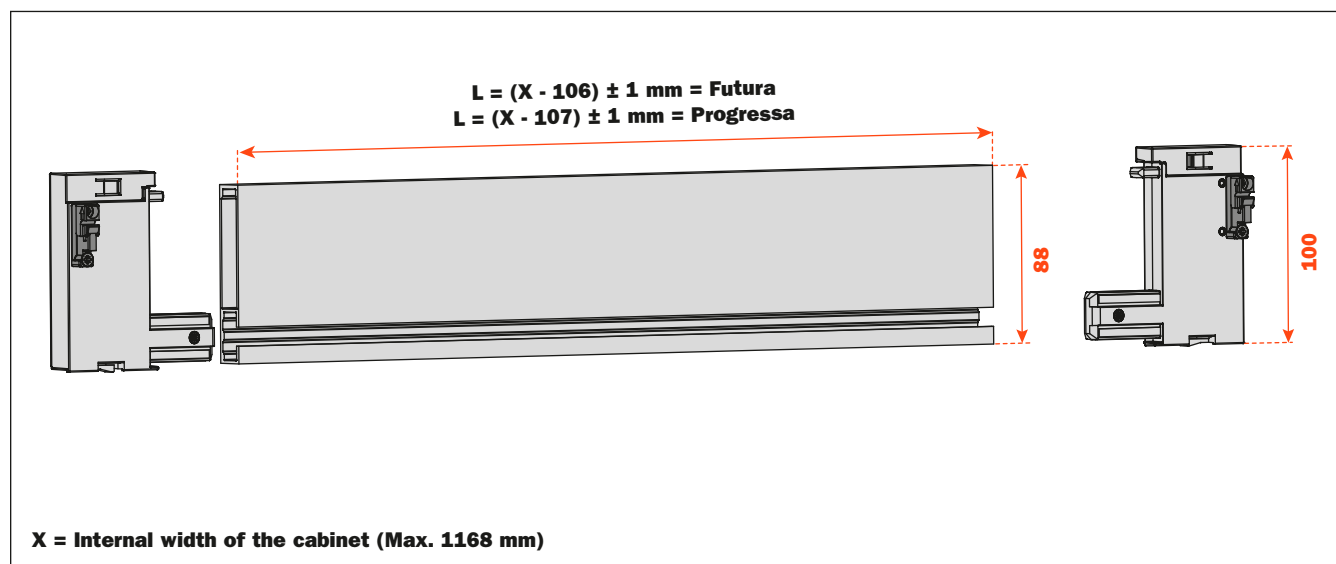

Insert the front panel adapters into the front panel and tighten the locking screws.  
Frontal fixings are already premounted.

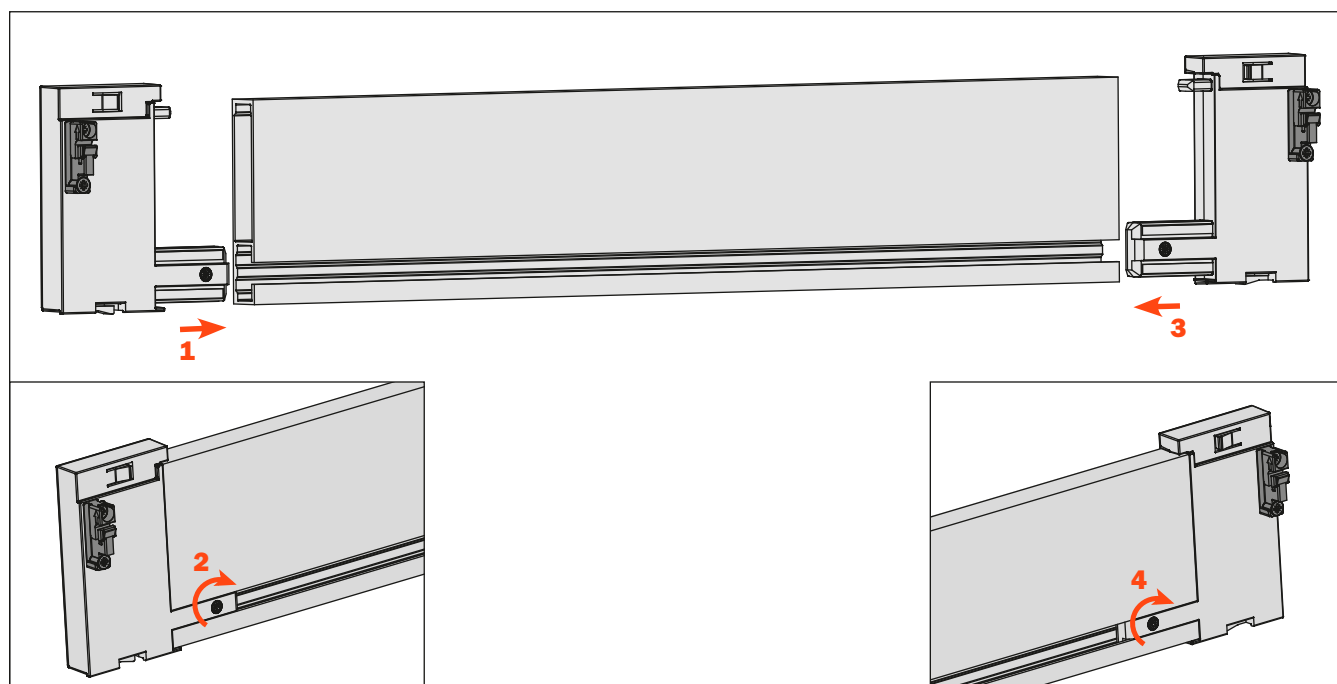

Fix the front panel to the drawer

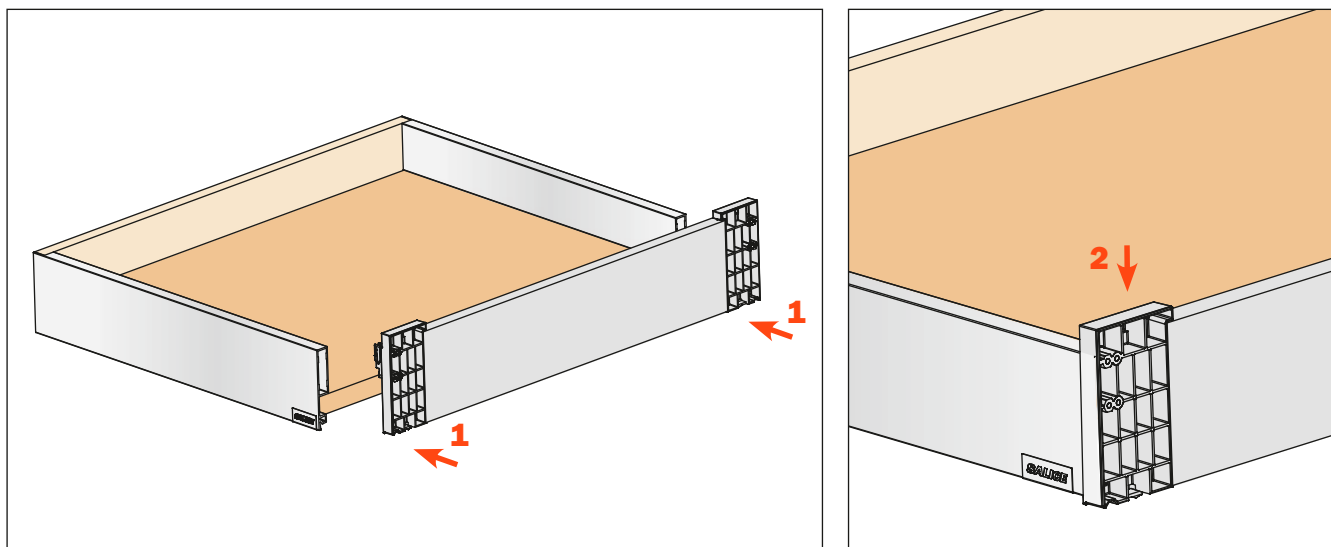

Fix the covers

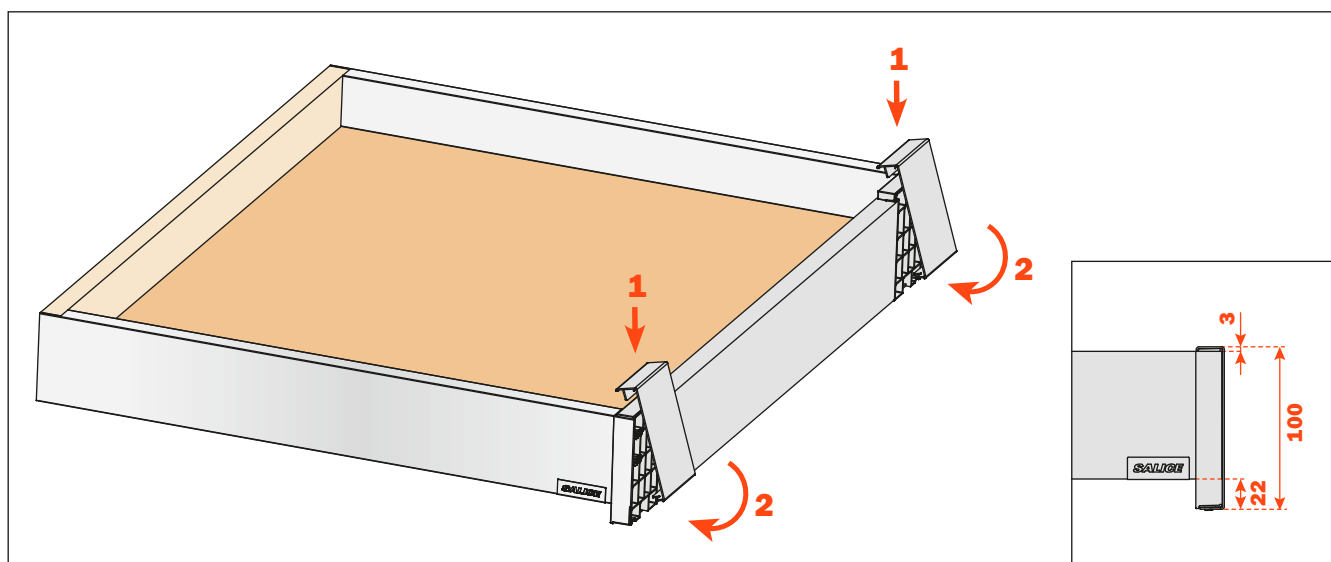

To correct any possible cutting errors of the panel, loosen and retighten the indicated screws

