

Assembly instructions

MOUNTING THE DRAWER ONTO THE RUNNERS

1. Place the drawer on the runners and close it
2. The flexibility of the fixing system enables the clips to engage
3. Engage the locking pin to prevent the overturning of the drawer
4. Locate the rear hooks

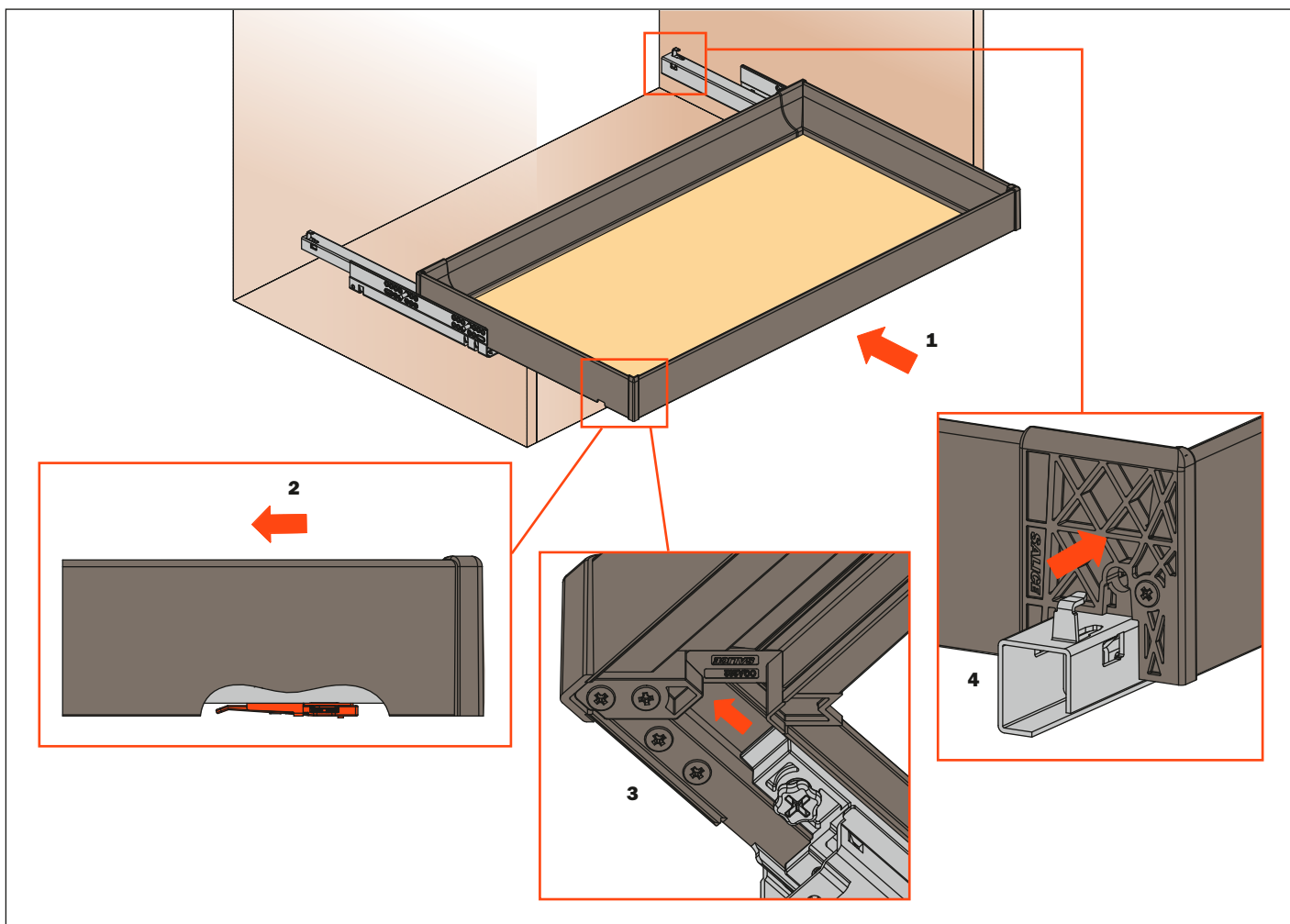

REMOVAL OF THE DRAWER

1. Open the drawer
2. Press down the lever indicated here below and pull out the drawer

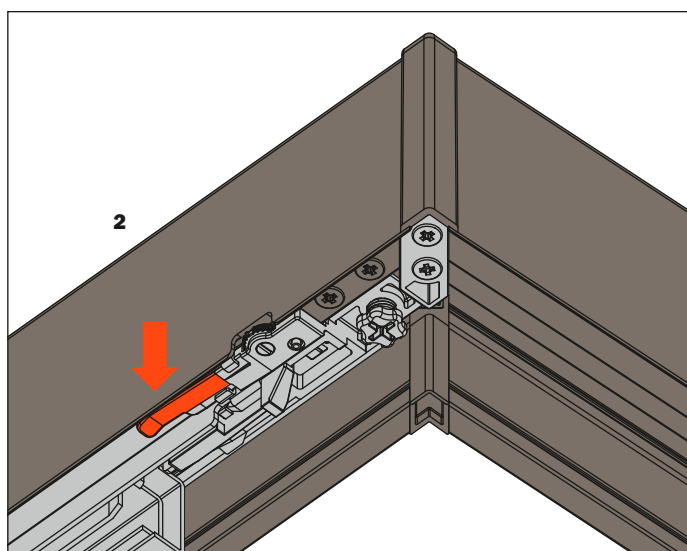
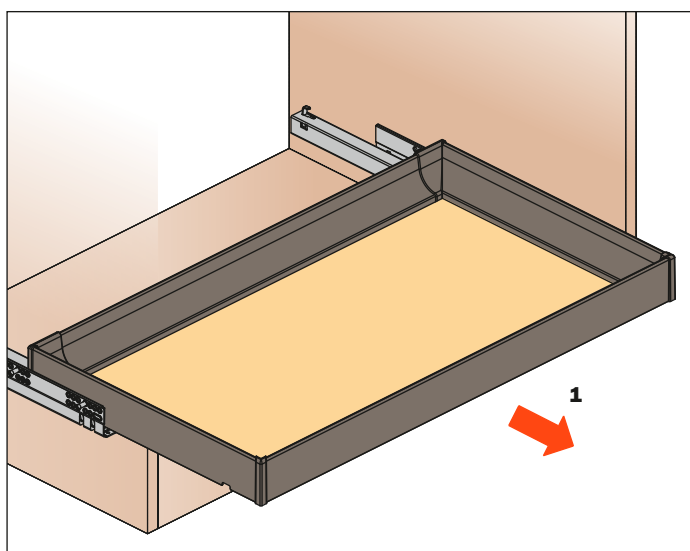

Excessories - modular drawer - Adjustments

Depth adjustment +2 -2 mm

Rotate the wheel towards the front of the drawer to move the drawer forward.
Rotate the wheel towards the back of the drawer to move the drawer backward.
This operation is tool free.

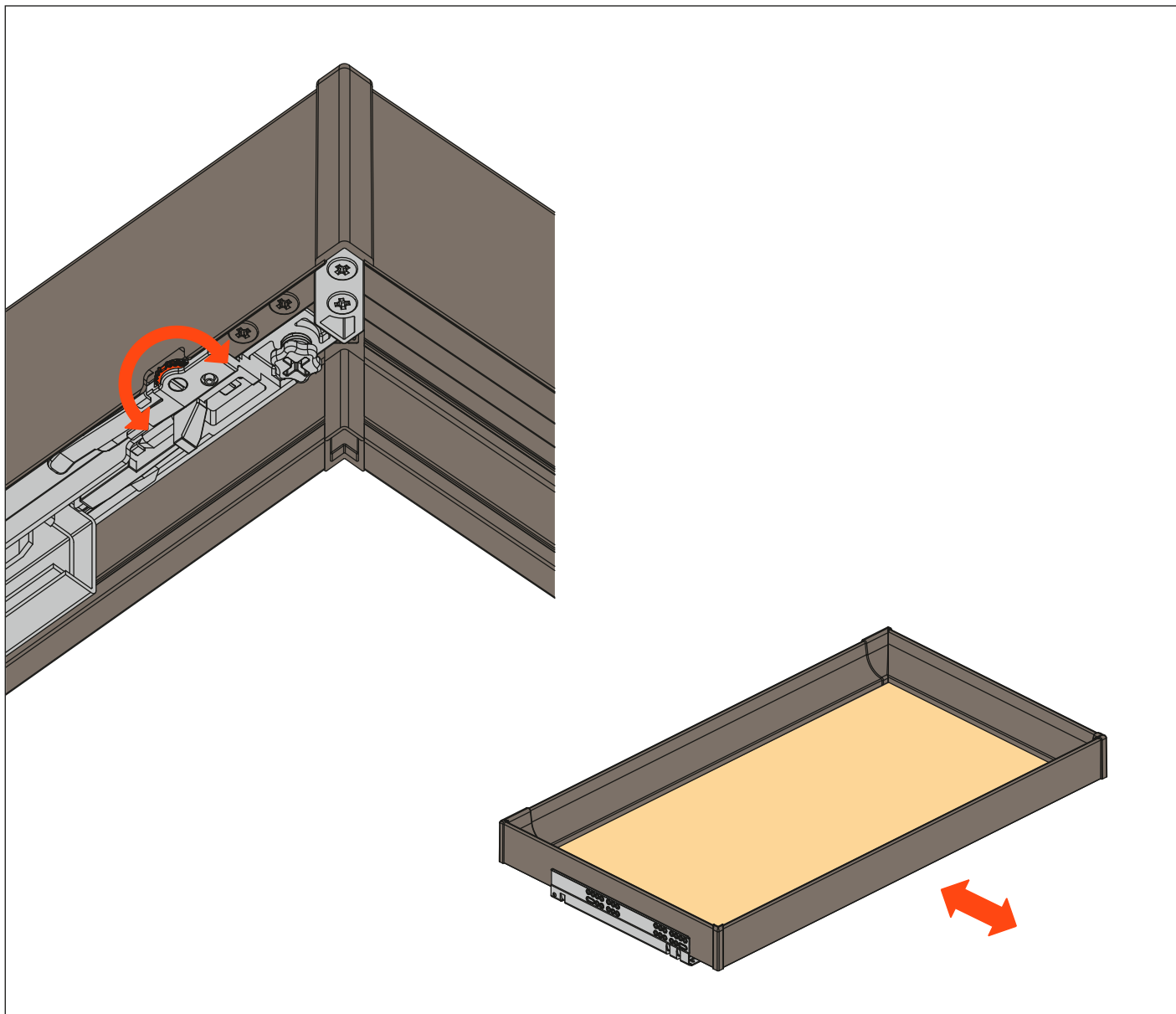

Adjustments

Height adjustment +5 mm

Rotate the lever towards the frontal of the drawer for the height adjustment.
This operation is tool free.

