

**S series**  
**Serie S**

**ecentra**

**“Face-Frame” • 2 cam adjustable**  
**para marco • 2 regulaciones con excéntricos**

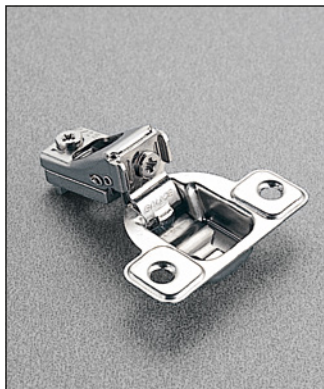

	106° ø35	106° ø35	106° ø35	106° ø35	Packaging Embalaje
<b>s/c</b>	CSP3Y99	CSP3Z99	CSP3999	CSP3899	300
<b>s/c</b>	CSR3Y99	CSR3Z99	CSR3999	CSR3899	300
Suggested frame fixing screw # 10 x 3/4" RHP. Tornillo de fijación aconsejado para marco # 10 x 3/4" RHP.					



<b>s/c</b>	CSP3799	CSP3699	CSP3599	CSP3499	300
<b>s/c</b>	CSR3799	CSR3699	CSR3599	CSR3499	300
Zero-door protrusion - Suggested frame fixing screw # 10 x 3/4" RHP. Puerta sin retroceso - Tornillo de fijación aconsejado para marco # 10 x 3/4" RHP.					



<b>s/c</b>	CSP3299N	CSP3199N	CSP3A99N	CSP3B99N	300
<b>s/c</b>	CSR3299N	CSR3199N	CSR3A99N	CSR3B99N	300
Zero-door protrusion - Suggested frame fixing screw # 10 x 1" RHP. Puerta sin retroceso - Tornillo de fijación aconsejado para marco # 10 x 1" RHP.					

<b>s/c</b>	CSP3C99N	CSP3D99N	CSP3E99N		300
<b>s/c</b>	CSR3C99N	CSR3D99N	CSR3E99N		300
Zero-door protrusion - Suggested frame fixing screw # 10 x 3/4" RHP. Puerta sin retroceso - Tornillo de fijación aconsejado para marco # 10 x 3/4" RHP.					

**Adjustments**  
**Regulación**

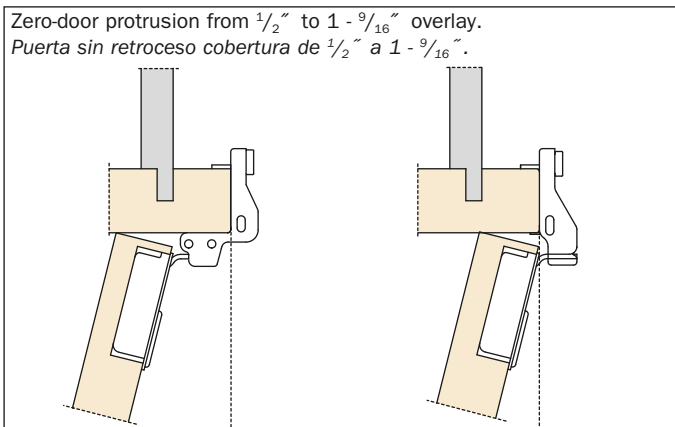

- D** = required door overlay
- T** = max. door thickness
- K** = drilling distance
- A** = reveal
- L** = gap between door and frame

- Stamped steel
- Cup depth 11 mm ( $\frac{7}{16}$ " )
- Opening 106° degrees
- K fixed at 2.5 mm ( $\frac{3}{32}$ " )
- L = 4.6 mm ( $\frac{3}{16}$ " )
- **For overlays from  $\frac{1}{4}$ " through  $\frac{3}{4}$ " the "A" value = 8.3 mm for  $\frac{3}{4}$ " square edge doors at 90° opening.**
- **For overlays from 1" through  $1 - \frac{7}{16}$ " the "A" value = 5.2 mm for  $\frac{3}{4}$ " square edge doors at 90° opening.**

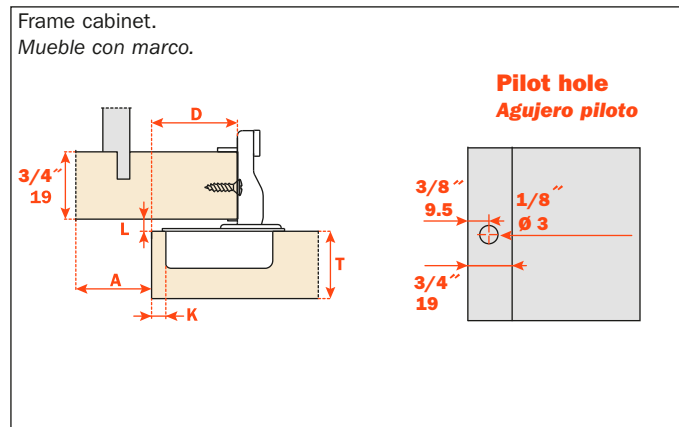

- D** = Cobertura de la puerta sobre el lateral
- T** = Espesor máx. de la puerta
- K** = Distancia taladro
- A** = Parte no cubierta del lateral
- L** = Distancia interna entre puerta y marco

- Acero moldeado
- Profundidad de la cazoleta 11 mm ( $\frac{7}{16}$ " )
- Abertura 106°
- K fijo a 2.5 mm ( $\frac{3}{32}$ " )
- L = 4.6 mm ( $\frac{3}{16}$ " )
- **Para coberturas desde  $\frac{1}{4}$ " hasta  $\frac{3}{4}$ " el valor "A" = 8.3 mm  $\frac{3}{4}$ " para puertas con esquina viva abertura 90°.**
- **Para coberturas desde 1" hasta  $1 - \frac{7}{16}$ " el valor "A" = 5.2 para puertas con esquina viva abertura 90°.**

Height adjustment  $\pm 2$  mm ( $\pm \frac{3}{32}$ " )  
Regulación vertical  $\pm 2$  mm ( $\pm \frac{3}{32}$ " )

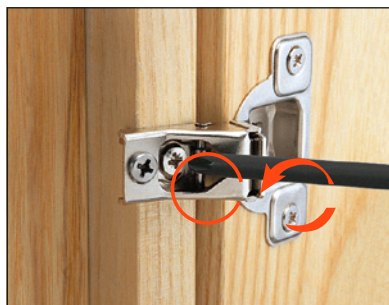
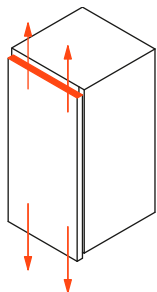

Depth adjustment by eccentric cam  
**+2.5 mm (+  $\frac{7}{64}$ " ), - 0.5 mm (-  $\frac{1}{64}$ " )**  
Regulación frontal mediante excéntrico  
**+2.5 mm (+  $\frac{7}{64}$ " ), -0.5 mm (-  $\frac{1}{64}$ " )**

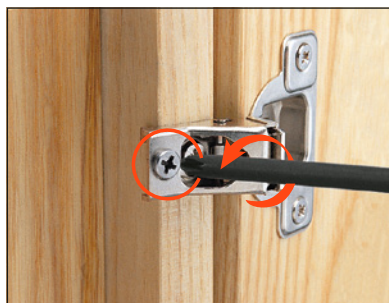
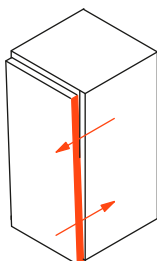

Side adjustment by eccentric cam for hinges:  
- CS\_3Y99; CS\_3Z99; CS\_3999; CS\_3899; CS\_3799; CS\_3699;  
CS\_3599; CS\_3499,  
**+2.8 mm, -1.5 mm (+  $\frac{7}{64}$ " , -  $\frac{1}{16}$ " )**  
- CS\_3299N; CS\_3199N; CS\_3A99N; CS\_3B99N; CS\_3C99N;  
CS\_3D99N; CS\_3E99N;  
**+3 mm, -2 mm (+  $\frac{1}{8}$ " , -  $\frac{5}{64}$ " )**

Regulación lateral mediante excéntrico para bisagras:  
- CS\_3Y99; CS\_3Z99; CS\_3999; CS\_3899; CS\_3799; CS\_3699;  
CS\_3599; CS\_3499,  
**+2.8 mm, -1.5 mm (+  $\frac{7}{64}$ " , -  $\frac{1}{16}$ " )**  
- CS\_3299N; CS\_3199N; CS\_3A99N; CS\_3B99N; CS\_3C99N;  
CS\_3D99N; CS\_3E99N;  
**+3 mm, -2 mm (+  $\frac{1}{8}$ " , -  $\frac{5}{64}$ " )**

