

Futura Push synchroniser

The synchronisation system for Push-open Futura runners has been developed to ensure that drawers of any width can be opened with minimum effort.

The system links the two runners, which thus become a single element; a pressure at any point of the drawer frontal (even at the extremities), is sufficient for the Push devices to release and consequently for the drawer to self-open.

The synchroniser can be used with any drawer width; its functionality is at its best with wider drawers. It can be used on drawers of any width; however it is recommended for drawers over 80 cm in width.

Product features:

- perfectly silent sliding movement
- the load capacity of the runner remains unchanged
- available on all runner lengths
- min. width of the cabinet (X) = 280 mm
- max. width of the cabinet (X) = 1300 mm
- bar length = 1150 mm (to cut to length)



Technical information - Formula for cutting the bar to length

Part-extension

The assembly of the synchroniser requires a minimum 80 mm wide notch in the rear panel.

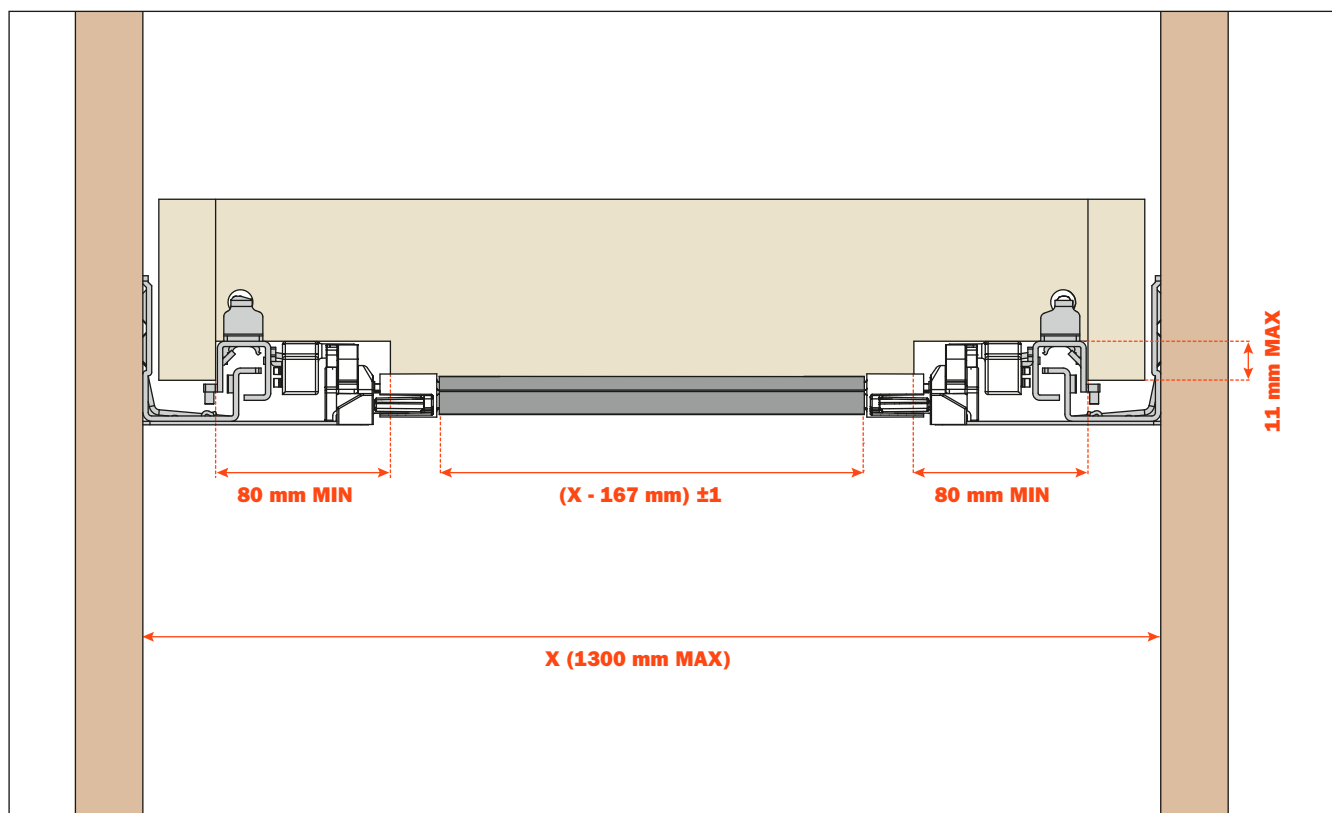

Full-extension

The assembly of the synchroniser requires a minimum 80 mm wide notch in the rear panel.

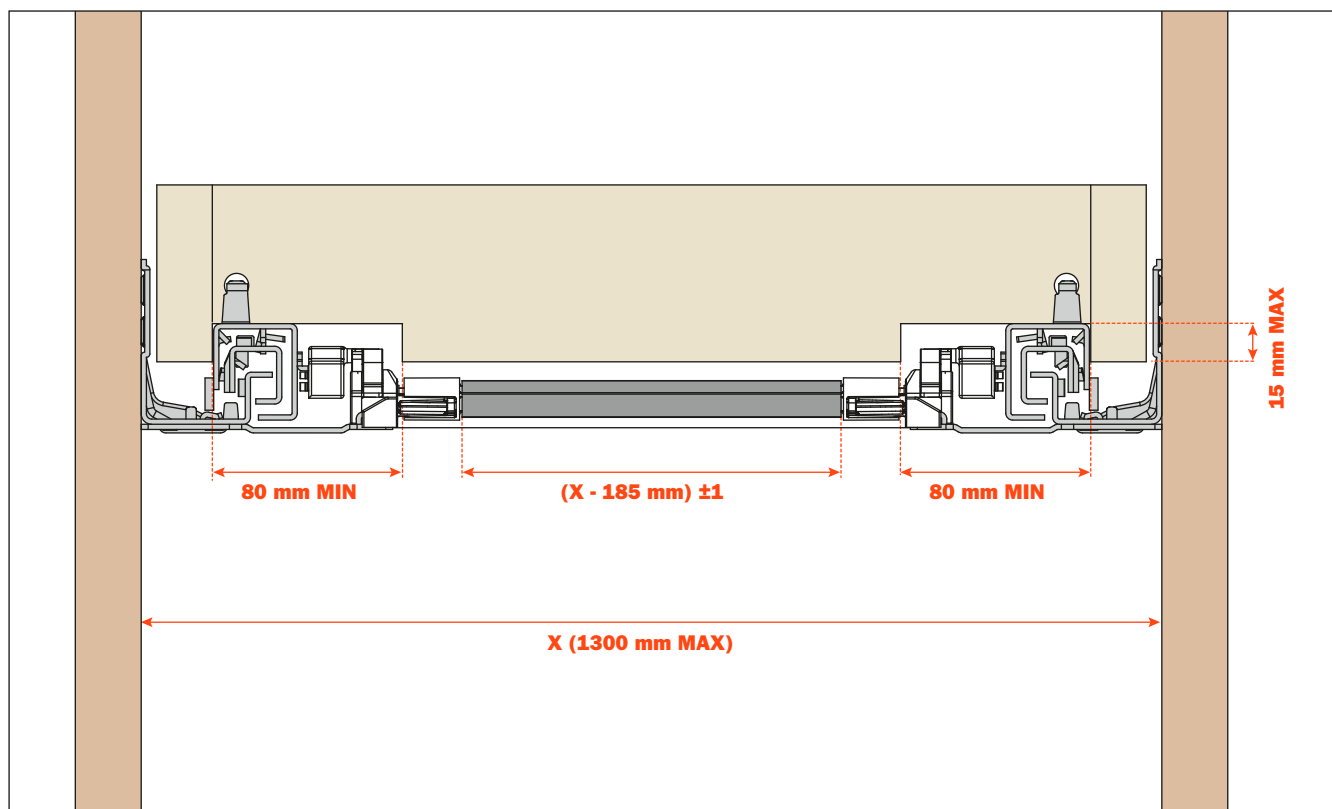

Futura Push synchroniser - Part-extension - Assembly instructions

Fitting the driver pins to the runners

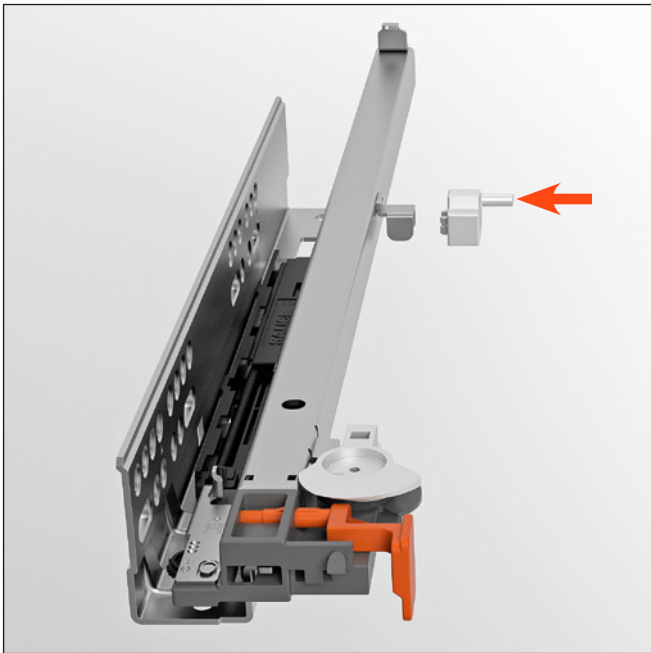

Slide the carrier plates into position on the runners in the direction indicated by the arrows

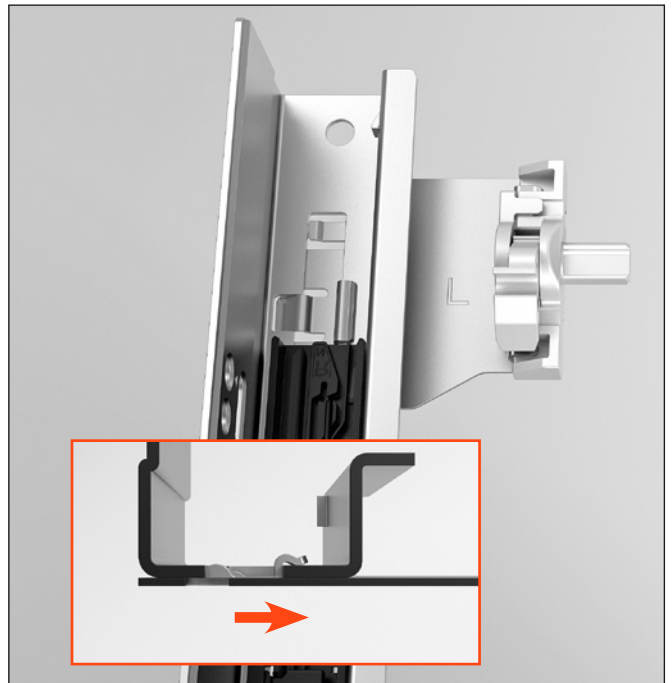
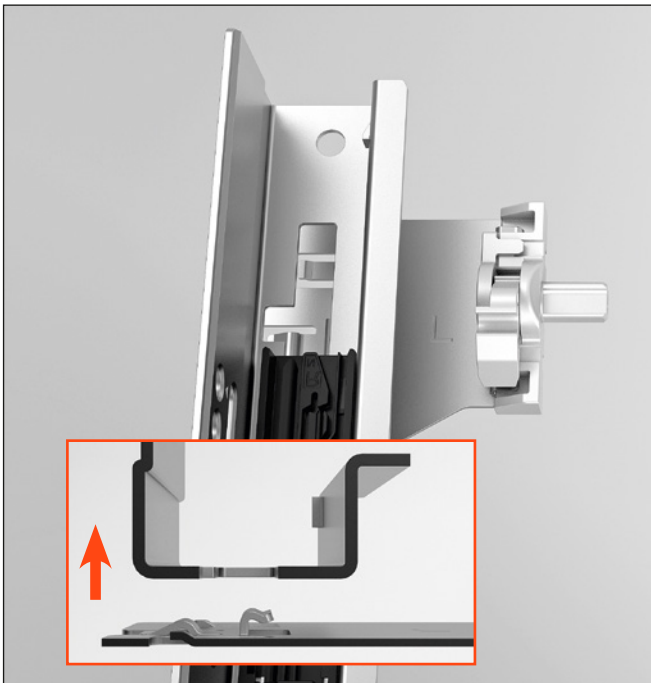

Screw-fix the runners to the cabinet side



Cut the stabiliser bar to length



Part-extension - Assembly instructions

1. Press the end caps onto the bar
2. Fix the bar to the plates

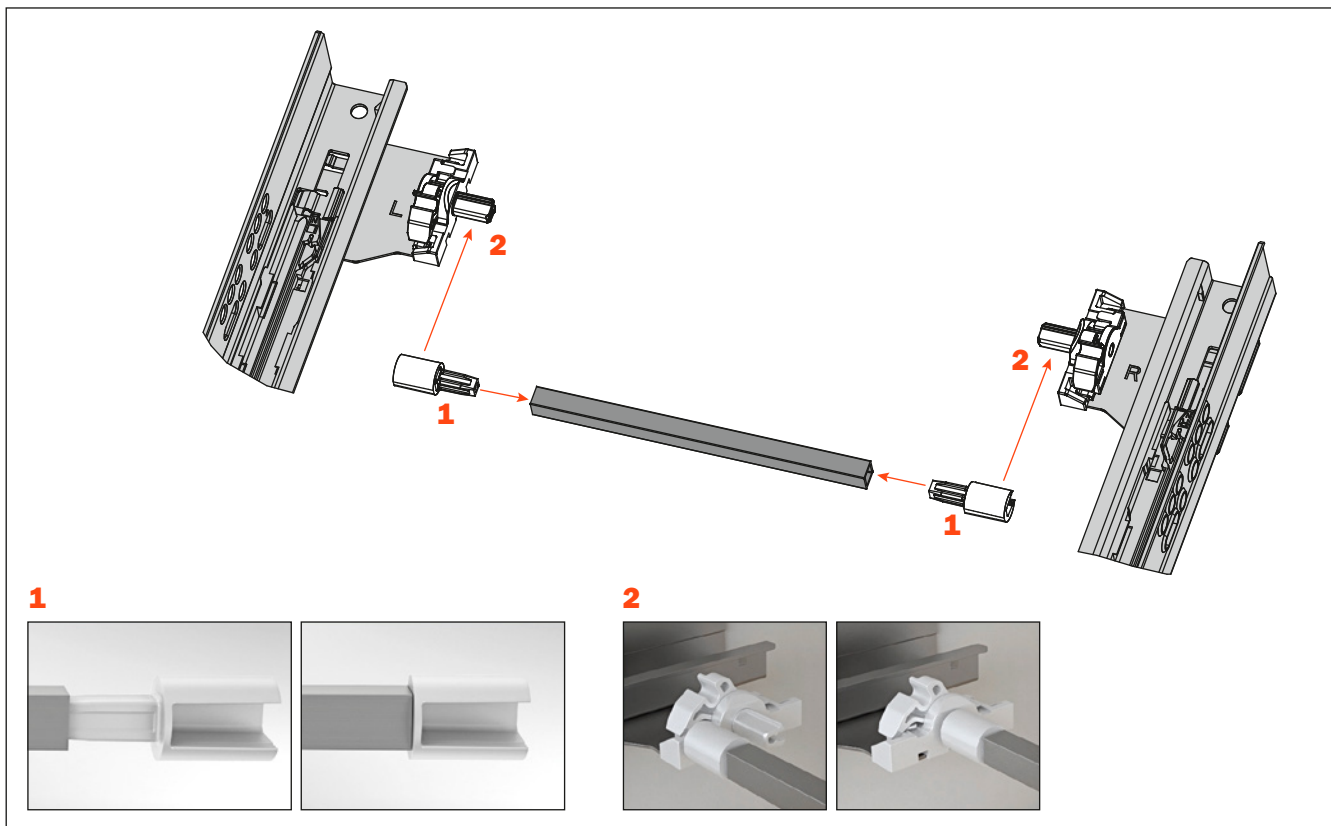

Insert the drawer



A pressure at any point on the drawer frontal is sufficient for the drawer to self-open

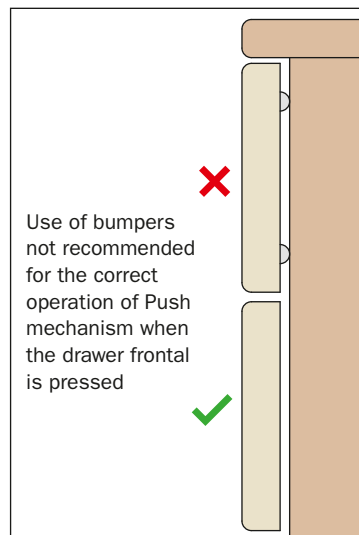
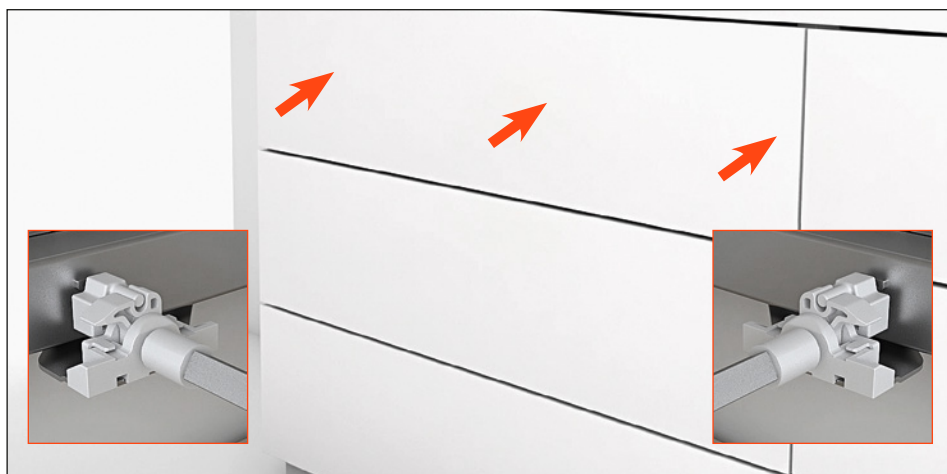

Futura Push synchroniser - Full-extension - Assembly instructions

Fitting the driver pins to the runners

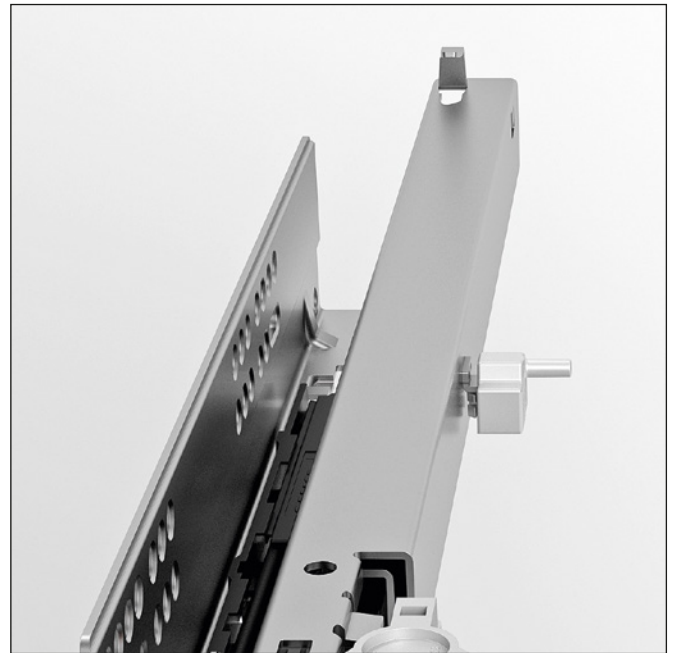
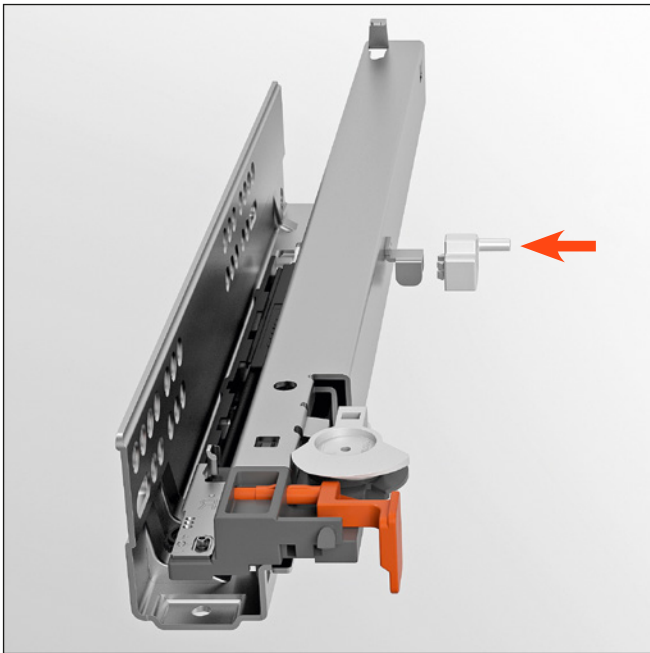

Slide the carrier plates into position on the runners in the direction indicated by the arrows

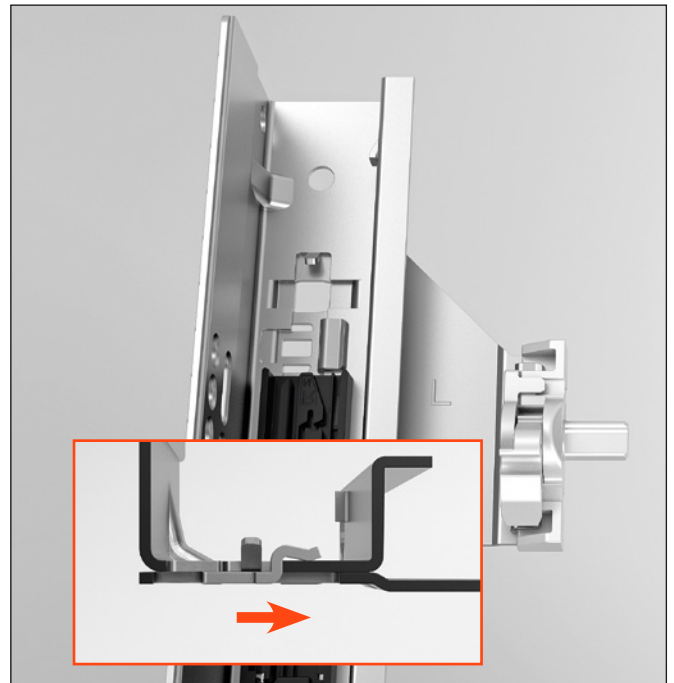
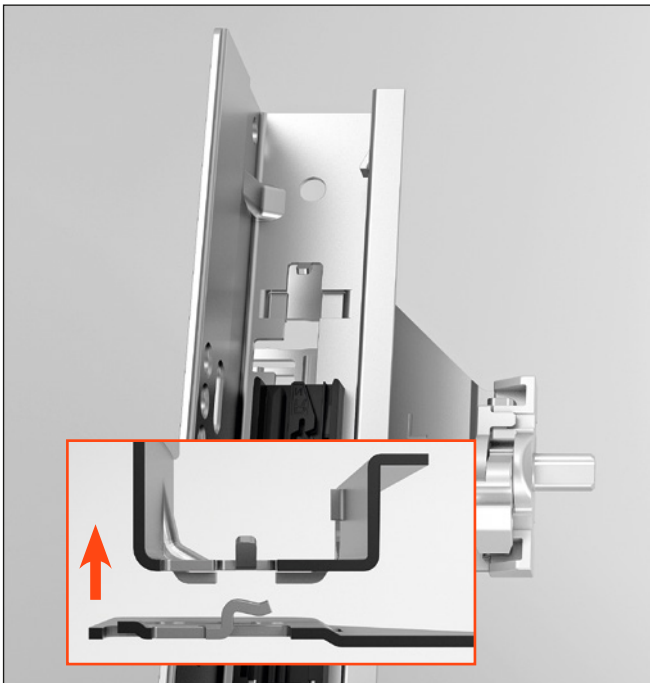

Screw-fix the runners to the cabinet side

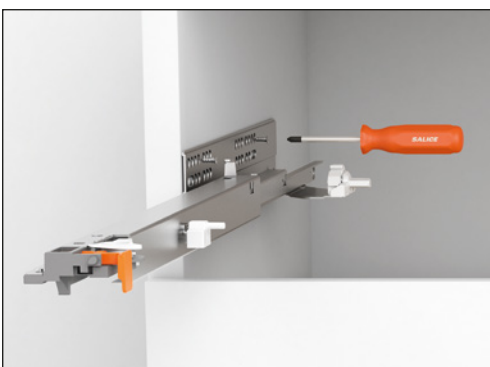

Cut the stabiliser bar to length



Assembly instructions

1. Press the end caps onto the bar
2. Fix the bar to the plates

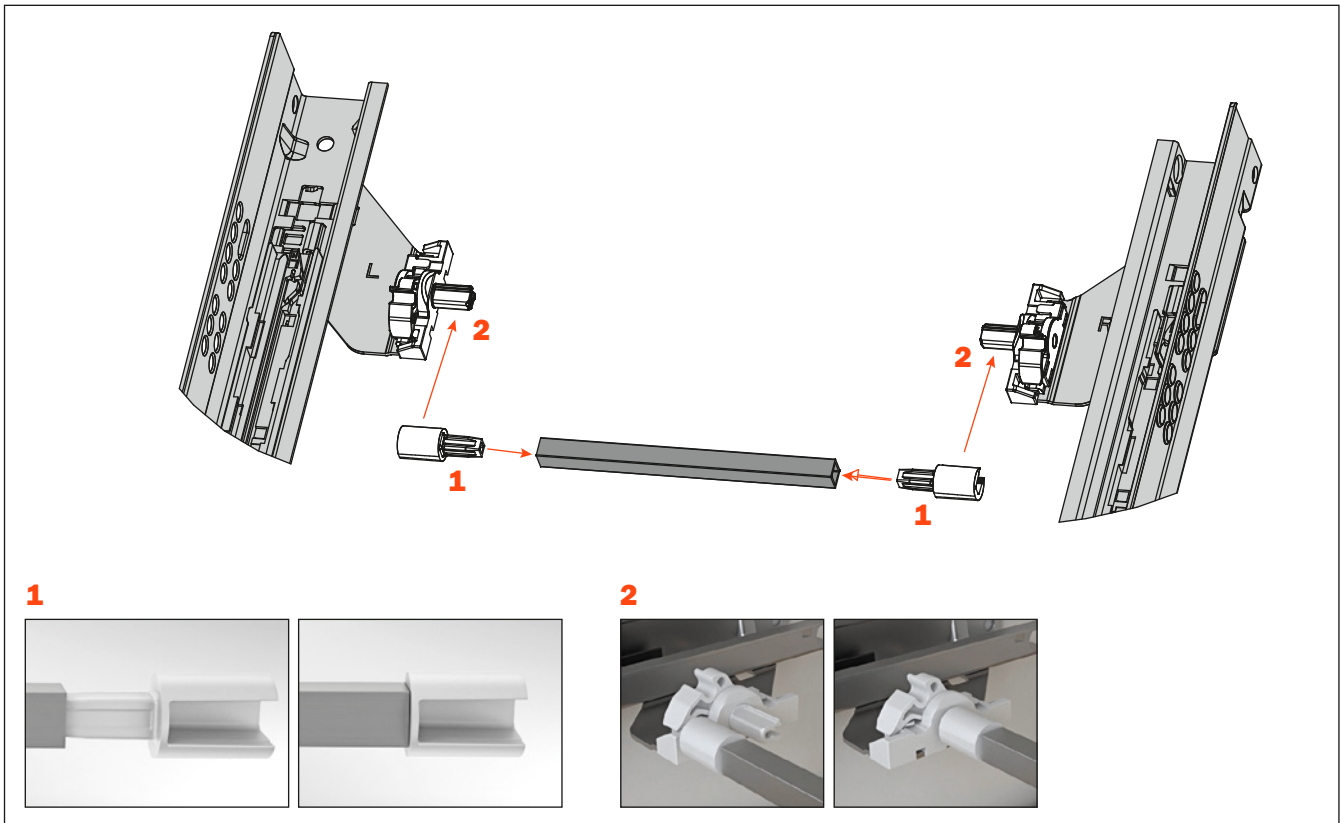

Insert the drawer

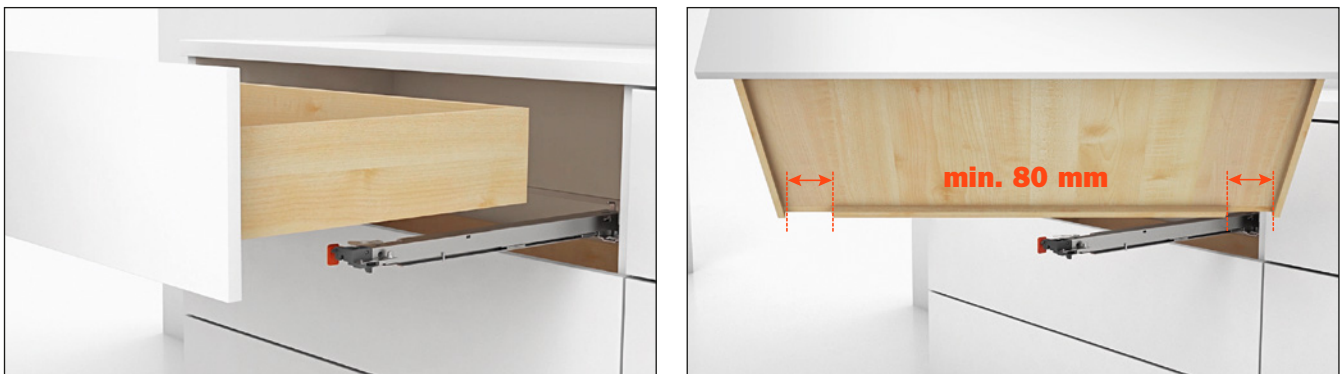

A pressure at any point on the drawer frontal is sufficient for the drawer to self-open

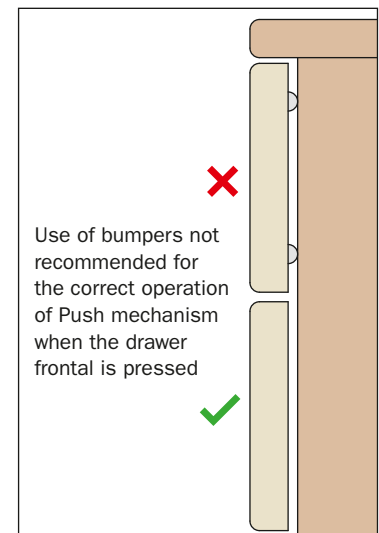
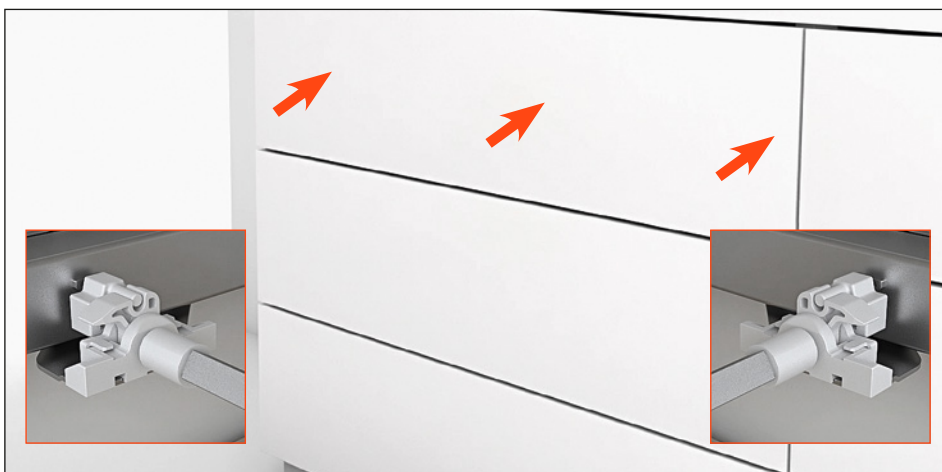

Futura Push synchroniser - Packing

SINGLE PACKING

APKFGP51150

Part-extension

PACKING

1 BOX = 20 single kits

1 KIT:

- 1 stabiliser bar
- 2 end caps
- 2 driver pins
- 1 right carrier plate and 1 left carrier plate



APKFGT51150

Full-extension

PACKING

1 BOX = 20 single kits

1 KIT:

- 1 stabiliser bar
- 2 end caps
- 2 driver pins
- 1 right carrier plate and 1 left carrier plate



INDUSTRIAL PACKING

APKIGP51150

Part-extension

PACKING = 100 kits

1 KIT:

- 1 BOX = 100 stabiliser bars
- 200 end caps
- 200 driver pins
- 1 BOX = 100 right carrier plates
- 1 BOX = 100 left carrier plates

APKIGT51150

Full-extension

PACKING = 100 kits

1 KIT:

- 1 BOX = 100 stabiliser bars
- 200 end caps
- 200 driver pins
- 1 BOX = 100 right carrier plates
- 1 BOX = 100 left carrier plates

